

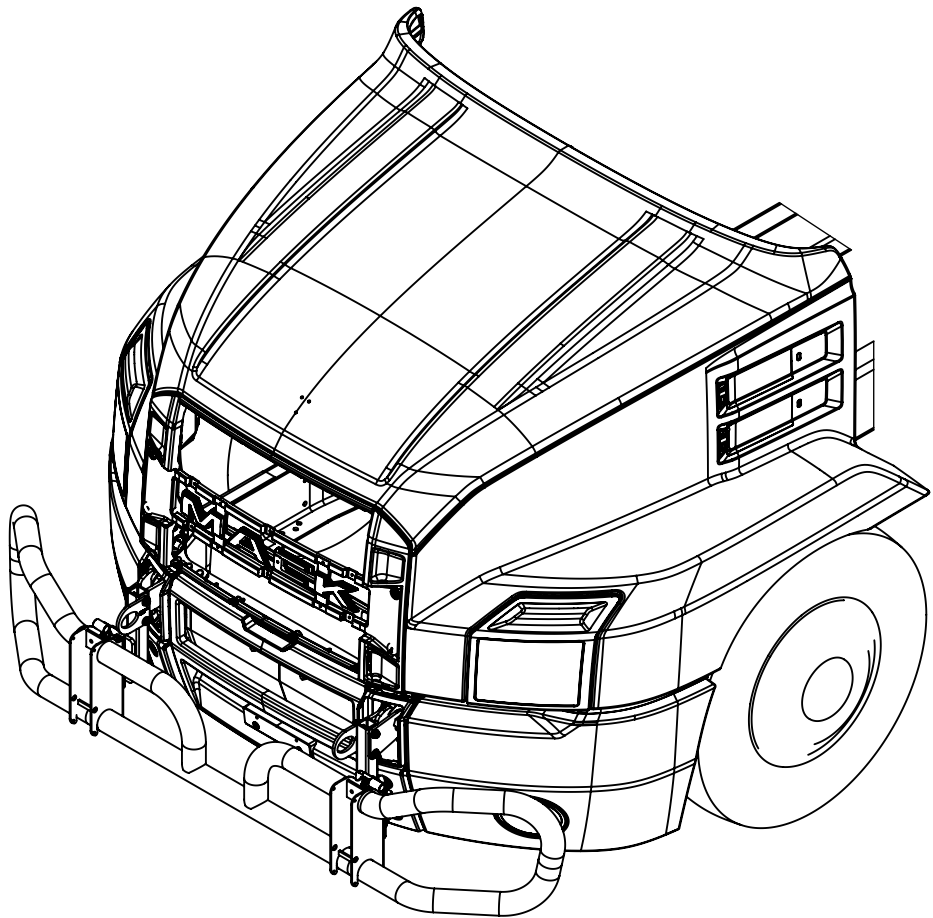

INSTALLATION GUIDE

MODEL NUMBER: MK02MGB1 / MK02MGB2 / MK02MGB3
TRUCK MODEL: 2017 MACK ANTHEM (PLASTIC BUMPER) (TOW RECEIVERS)



IMPORTANT INFORMATION

- THIS GUIDE IS ONLY APPLICABLE TO PRODUCTS AND TRUCK MODELS SPECIFIED.
- THE CORRECT SIZE AND GRADE OF HARDWARE SPECIFIED IN THIS GUIDE MUST BE USED.
- CHECK ALL MOUNTING POINTS AFTER THE FIRST 5000KM'S IN SERVICE AND PERIODICALLY THERE AFTER. RE-TORQUE IF NECESSARY.
- RECOMMENDED ADDING THREADLOCKER (LOCTITE BLUE 242) TO ALL THREADS BEFORE INSTALLING.
- ALL MAGNUM PRODUCTS MUST BE INSTALLED ACCORDING TO THIS INSTALLATION GUIDE. ANY DEVIATIONS MAY RESULT IN VOID OF WARRANTY.
- ANY ALTERATIONS TO THE PRODUCT MAY RESULT IN VOID OF WARRANTY.

SAFETY INFORMATION

- PROPER PERSONAL PROTECTIVE EQUIPMENT MUST BE WORN WHEN INSTALLING THIS PRODUCT.
- SOME PARTS OF THIS PRODUCT MAY BE HEAVY OR AWKWARD TO HANDLE. USE CAUTION WHEN HANDLING.



INCLUDED PARTS

BK-002 BRACKET KIT AND MOUNT HARDWARE

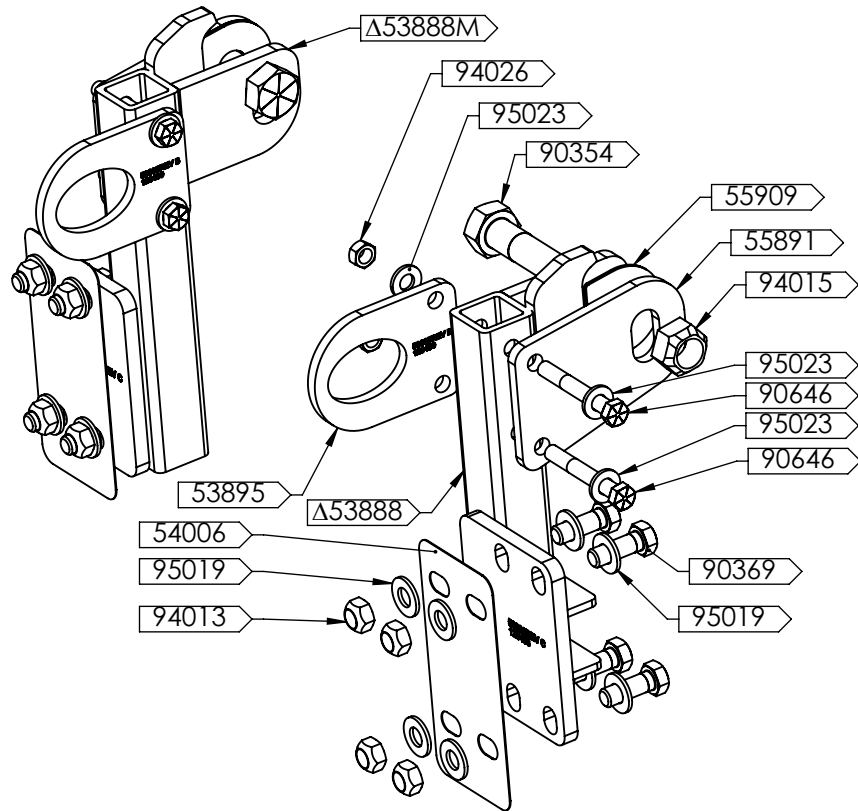

ITEM#	DESCRIPTION	MAT'L	DIMENSIONS	WT. EA	STOCK #	QTY.
53888	MOUNT BRACKET WELDMENT		ASSEMBLY	14.3	128431	1
53888M	MOUNT BRACKET WELDMENT - MIRROR		ASSEMBLY	14.3	128432	1
53895	TOW PLATE	A514	3/8" X 5 1/2" X 4"	1.6	128439	2
54006	MODULAR GRILLE GUARD SHIM	HDPE	1/32" X 4" X 8 3/8"	.033	128503	2
55891	BOLTED TOW PIN PLATE	A514	3/8" X 4 31/32" X 6 7/16"	2.4	129248	2
55909	SPACER SHIM	A36	16 GA. X 2 3/4" X 3 3/8"	.11	129249	4
90354	HEX HEAD BOLT - PLATED	GR. 8	1" NC X 3 1/2"	1.1	101839	2
90369	HEX HEAD CAPSCREW - PLATED	GR. 8	5/8" NC X 1 3/4"	.23	101974	8
90646	HEX CAPSCREW - PLATED	GR. 8	1/2" NC X 3 3/4"	.25	109316	4
94013	STOVER NUT - PLATED	GR. C	5/8" NC	.063	101481	8
94015	STOVER NUT - PLATED	GR. C	1" NC	.27	101474	2
94026	STOVER NUT - PLATED	GR. C	1/2" NC	.032	101475	4
95019	FLAT WASHER - PLATED	GR. 8	5/8" DIA SAE	.035	102172	16
95023	FLAT WASHER - PLATED	GR. 8	1/2" DIA SAE	.024	102167	8

GUARD OPTIONS: MG-100B/MG-200B/MG-300B

THREE DIFFERENT OPTIONS OF GUARD CAN BE INSTALLED ON THIS TRUCK USING THE BK-002 BRACKET KIT. THE INSTALLATION OF THE GUARD IS THE SAME ACROSS ALL THREE MODELS. PLEASE REFER TO DRAWING #54268 FOR INSTALLING THE 200T AND 300T ON THE MG-100B IF REQUIRED.

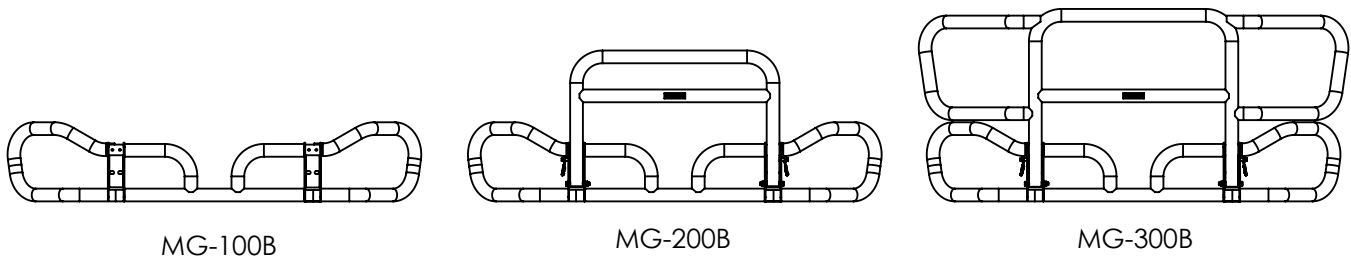



INSTALLATION PROCEDURE

1. REMOVE THE TOW CLEAVES FROM THE TRUCK. IN ORDER TO REMOVE THE TOW CELVISES YOU MAY HAVE TO UNINSTALL THE BUMPER. IF THE BUMPER IS REMOVED, INSTALL BACK THE BUMPER BEFORE MOVING ON WITH THE INSTALLATION OF THIS GUARD.

2. INSTALL THE 53888 MOUNT BRACKET WELDMENT ON THE DRIVER SIDE OF THE TRUCK AND THE 53888M ON THE PASSENGER SIDE OF THE TRUCK. THE TOP OF THE BRACKET SHOULD HOOK OVER THE FRONT OF THE TOW LOOP ON THE TRUCK AS SEEN IN THE FIGURE ON THE RIGHT. KEEP THE BRACKET IN POSITION BY INSERTING THE 90354 BOLT THROUGH THE 53888/53888M AND THE HOLE IN THE TRUCKS TOW HOLE.

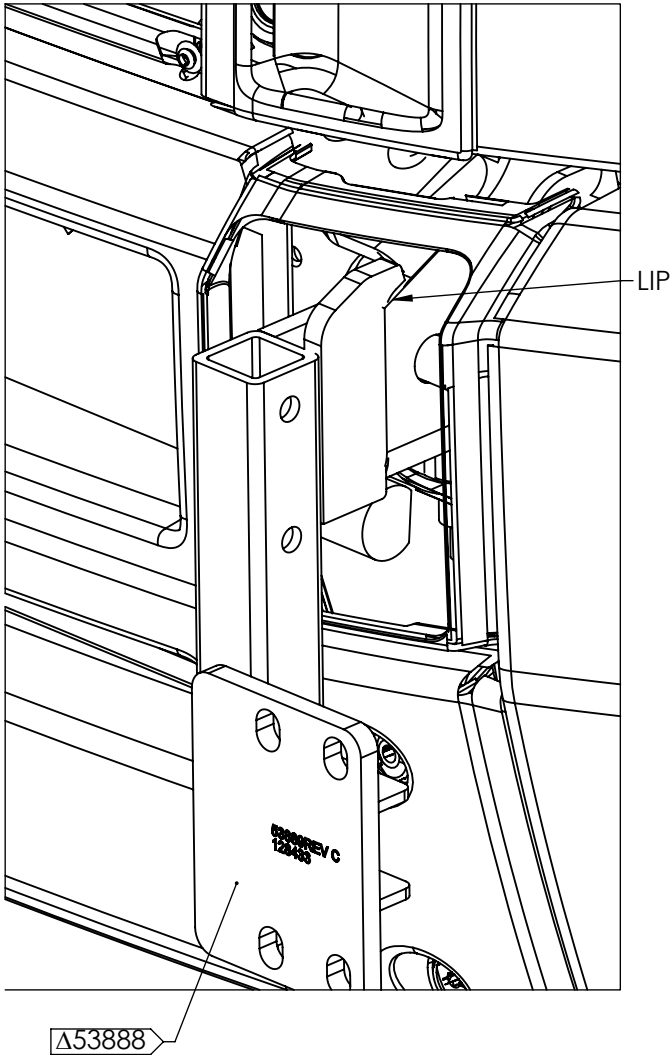
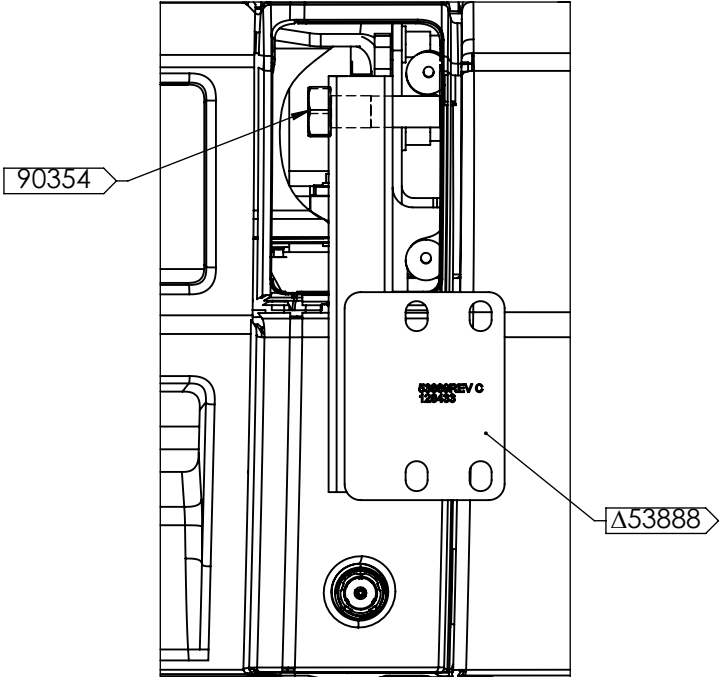
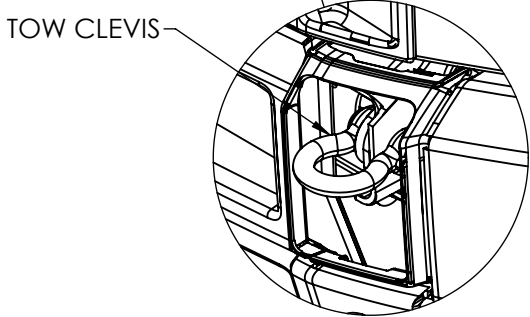
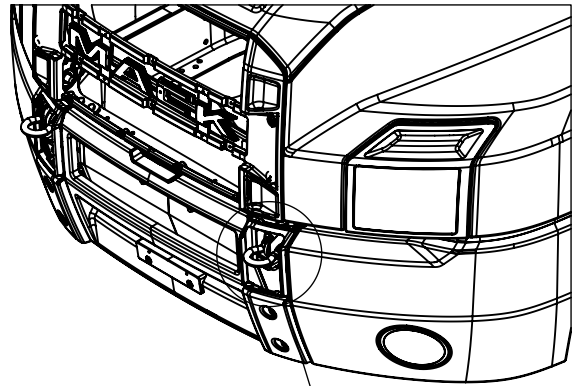

INSTALLATION PROCEDURE

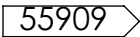
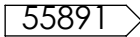
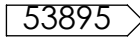
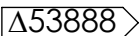
3. PLACE  SHIMS ON THE END OF THE BOLT TWO OF THEM PER SIDE. POSITION THE  AND  AS THE FIGURE TO THE RIGHT. SECURE THEM TO 

USING THE FOLLOWING HARDWARE:

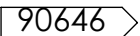
4 X  BOLTS

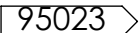
8 X  WASHERS

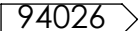
4 X  NUTS

TORQUE TO 53 FT-LBS (LUBRICATED) / 107 FT-LBS (DRY). REPEAT FOR OTHER SIDE OF TRUCK.

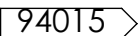
4. SECURE THE WHOLE BRACKET WITH THE  NUT.

TORQUE TO 400 FT-LBS (LUBRICATED) / 600 FT-LBS (DRY). REPEAT FOR OTHER BRACKET.

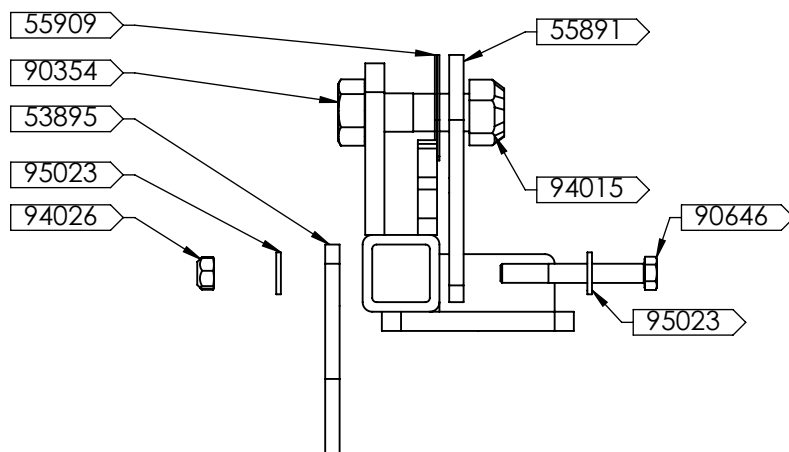
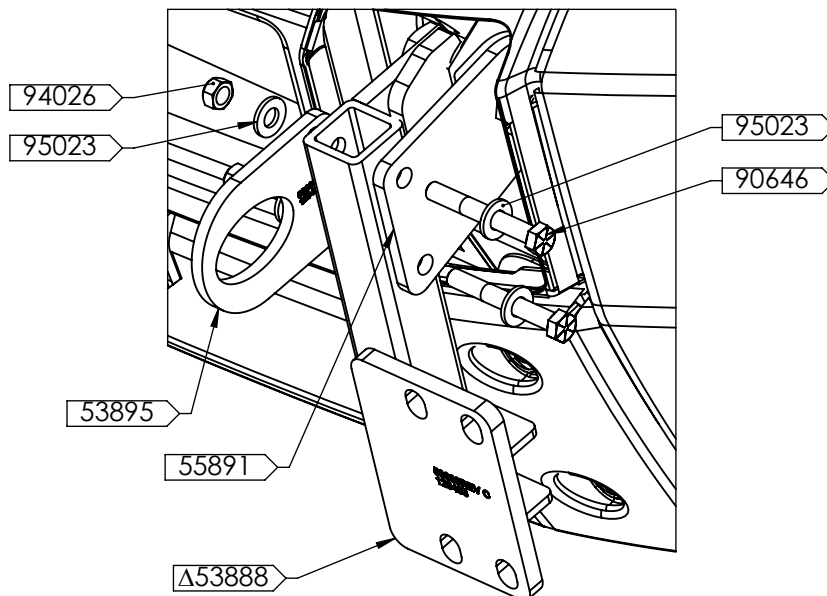
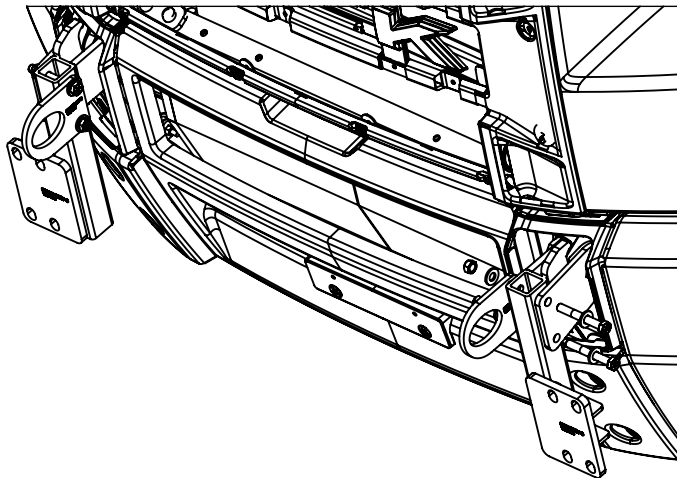

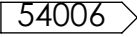
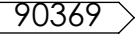
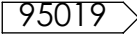

INSTALLATION PROCEDURE

5. POSITION THE  SHIM IN FRONT OF BOTH MOUNT BRACKETS AS SEEN IN THE FIGURE. TO KEEP THE SHIM IN POSITION INSERT A COUPLE OF THE  BOLTS WITH A  WASHER THROUGH THE MOUNT BRACKET AND SHIM.

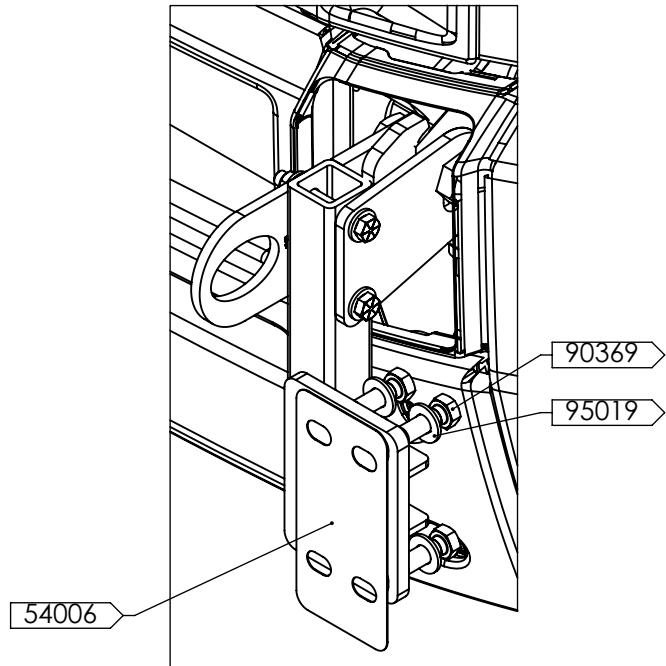

6. ATTACH THE MG-100B TO THE MOUNTING BRACKETS USING THE TOP ROWS OF SLOTS ON THE GUARD. USE THE FOLLOWING HARDWARE TO ATTACH THE GUARD:

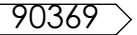
8 X  BOLTS

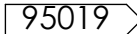
16 X  WASHERS

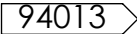
8 X  NUTS

TORQUE TO 159 FT-LBS (LUBRICATED) / 212 FT-LBS (DRY).

