

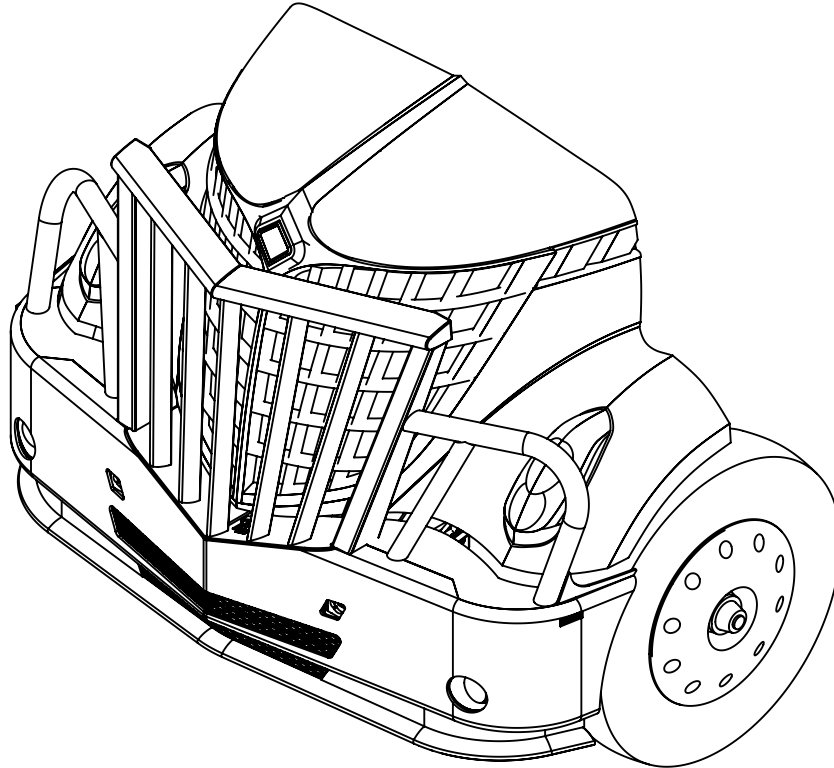

INSTALLATION GUIDE

MODEL NUMBER: 17072

TRUCK MODEL: 2009+ INTERNATIONAL LONESTAR



IMPORTANT INFORMATION

- THIS GUIDE IS ONLY APPLICABLE TO PRODUCTS AND TRUCK MODELS SPECIFIED.
- THE CORRECT SIZE AND GRADE OF HARDWARE SPECIFIED IN THIS GUIDE MUST BE USED.
- CHECK ALL MOUNTING POINTS AFTER THE FIRST 5000KM'S IN SERVICE AND PERIODICALLY THERE AFTER. RE-TORQUE IF NECESSARY.
- RECOMMENDED ADDING THREADLOCKER (LOCTITE BLUE 242) TO ALL THREADS BEFORE INSTALLING.
- ALL MAGNUM PRODUCTS MUST BE INSTALLED ACCORDING TO THIS INSTALLATION GUIDE. ANY DEVIATIONS MAY RESULT IN VOID OF WARRANTY.
- ANY ALTERATIONS TO THE PRODUCT MAY RESULT IN VOID OF WARRANTY.

SAFETY INFORMATION

- PROPER PERSONAL PROTECTIVE EQUIPMENT MUST BE WORN WHEN INSTALLING THIS PRODUCT.
- SOME PARTS OF THIS PRODUCT MAY BE HEAVY OR AWKWARD TO HANDLE. USE CAUTION WHEN HANDLING.

17072 MOOSE BUMPER

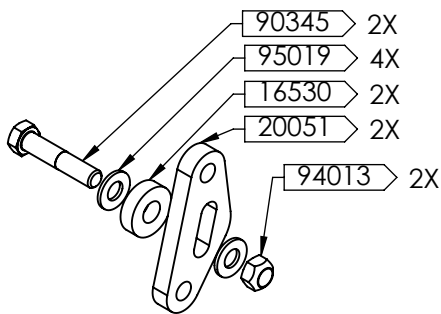
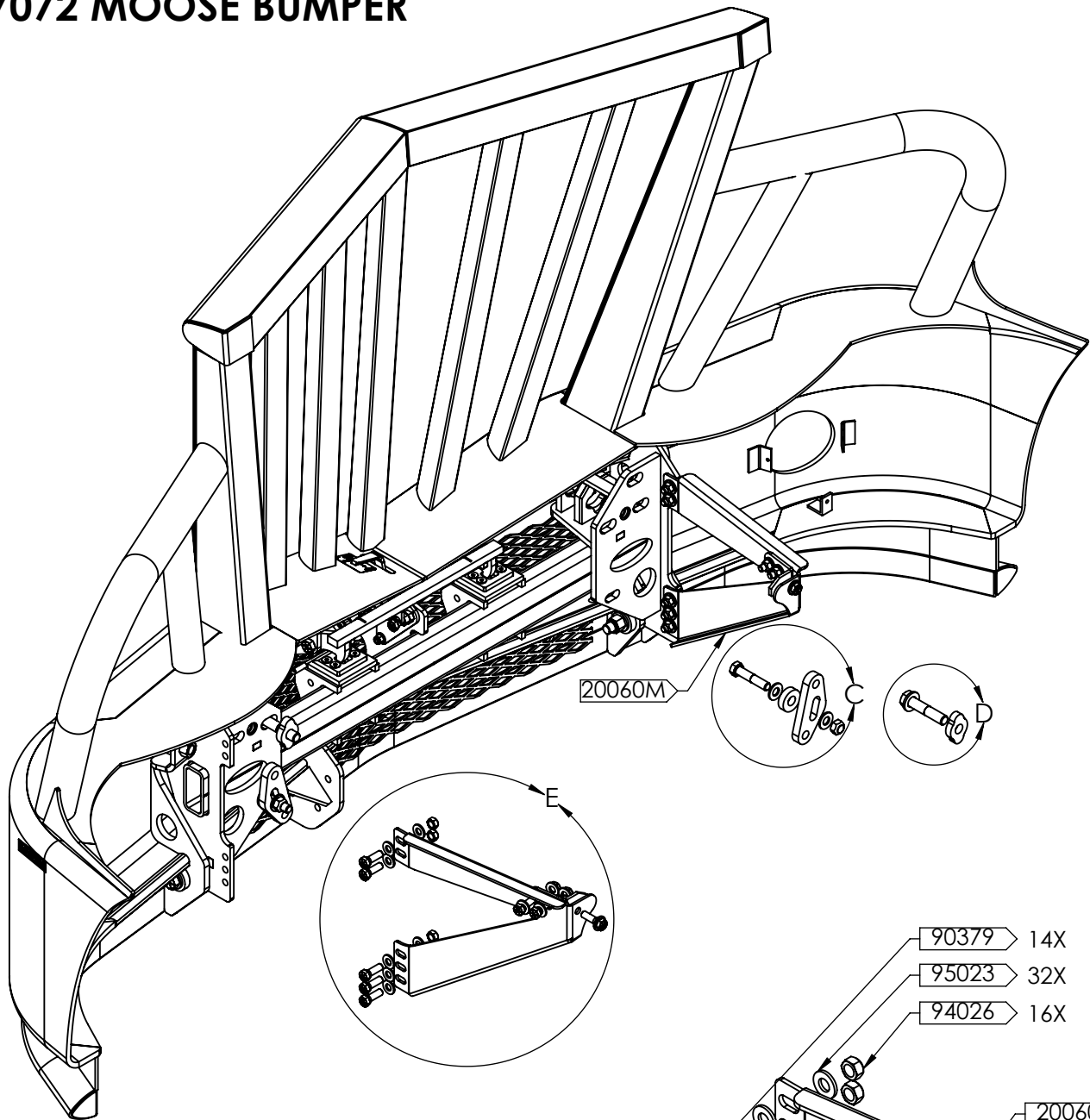

DETAIL C
SCALE 1 : 6

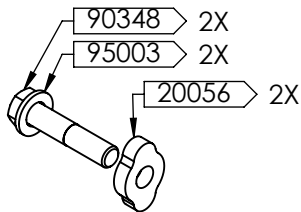

DETAIL D
SCALE 1 : 6

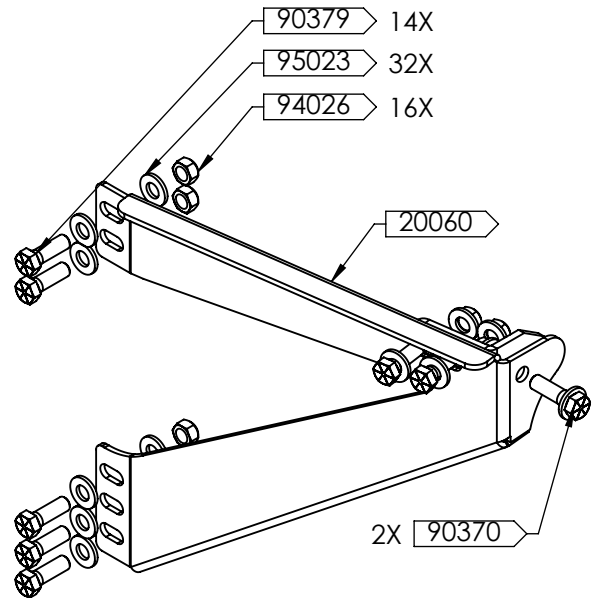

DETAIL E
SCALE 1 : 6



ASSEMBLY KIT PARTS

ITEM#	DWG	DESCRIPTION	MAT'L	DIMENSIONS	WT. EA	STOCK #	QTY.
16530	PA	SPACER	A36	SEE PA - 16530	.28	106433	2
20051	PA	MOUNT PLATE	44W	SEE PA - 20051	1.4	108274	2
20056	PA	TOW MOUNT INSERT	44W	SEE PA - 20056	.36	108275	2
20060	PB	BRACE	44W	SEE PB - 20060	7.	108276	1
20060M	PB	BRACE- MIRROR	44W	SEE PB - 20060M	7.	108277	1
20061	PA	MOUNT BRACKET	44W	SEE PA - 20061	.54	108278	2
90345		HEX HEAD BOLT - PLATED	GR. 8	5/8" NC X 3"	.34	101980	2
90348		HEX HEAD CAPSCREW - PLATED	GR. 8	3/4" NC X 3 1/2"	.58	101876	2
90370		HEX HEAD BOLT - PLATED	GR. 8	1/2" NC X 1 3/4"	.14	101763	2
90379		HEX CAPSCREW - PLATED	GR. 8	1/2" NC X 1 1/2"	.12	101761	14
94013		STOVER NUT - PLATED	GR. C	5/8" NC	.063	101481	2
94026		STOVER NUT - PLATED	GR. C	1/2" NC	.032	101475	16
95003		FLAT WASHER - PLATED	GR. 8	3/4" DIA SAE	.055	102169	2
95019		FLAT WASHER - PLATED	GR. 8	5/8" DIA SAE	.035	102172	4
95023		FLAT WASHER - PLATED	GR. 8	1/2" DIA SAE	.024	102167	32



INSTALLATION PROCEDURE

1. UNINSTALL THE OEM BUMPER FROM THE TRUCK AND UNINSTALL THE LAMPS FROM THE BUMPER.

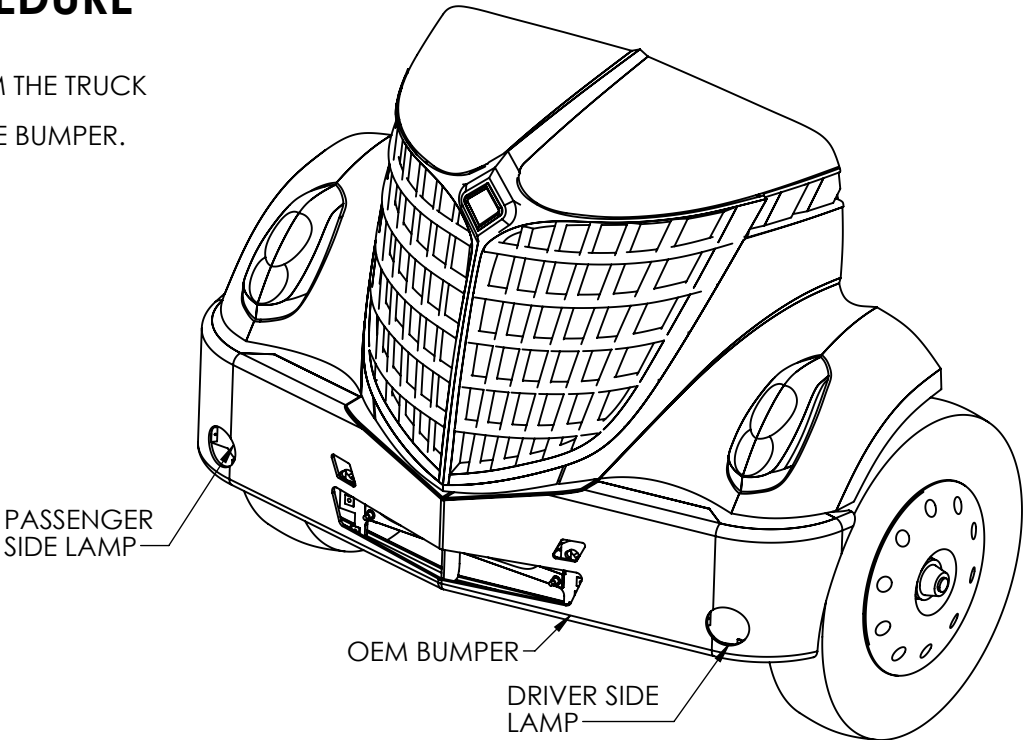

2. ENLARGE THE HOLE SHOWN IN THE FIGURE TO THE RIGHT. REPEAT FOR BOTH SIDES OF THE TRUCK.

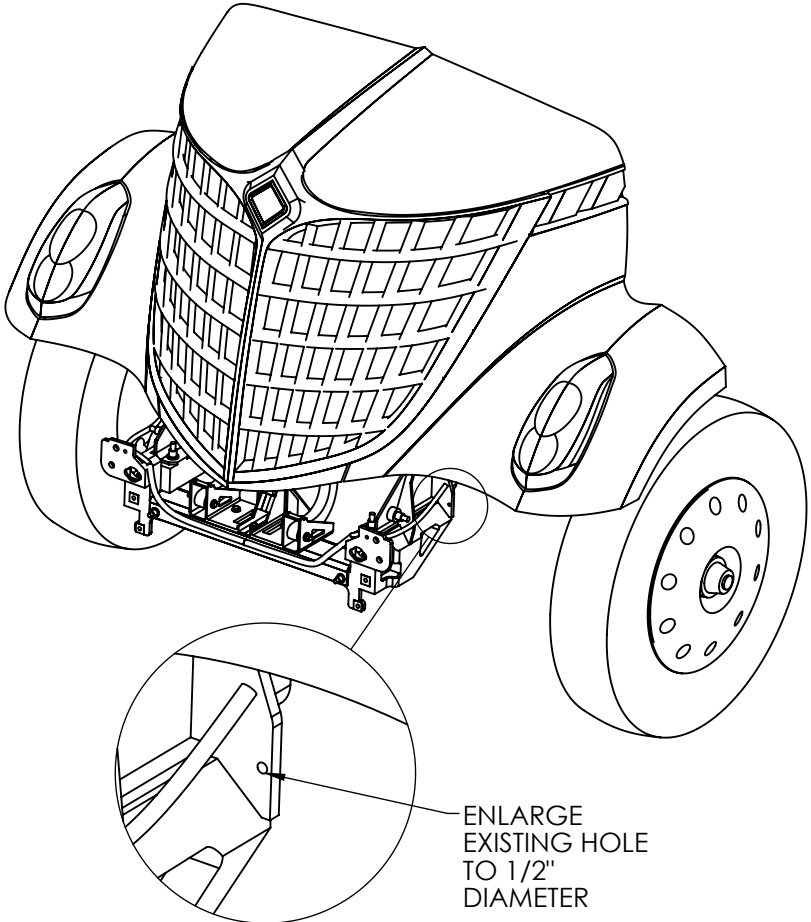

INSTALLATION PROCEDURE

3. INSTALL THE MOUNT PLATES **20051**

ON BOTH SIDES OF THE TRUCK USING THE FOLLOWING HARDWARE:

- 4 X M12 X 1.75 X 40 CL 10.9 HEX BOLT (NOT SUPPLIED)
- 4 X M12 CL10.9 FLAT WASHER (NOT SUPPLIED)

TORQUE TO 35 FT-LBS (LUBRICATED) / 50 FT-LBS (DRY).

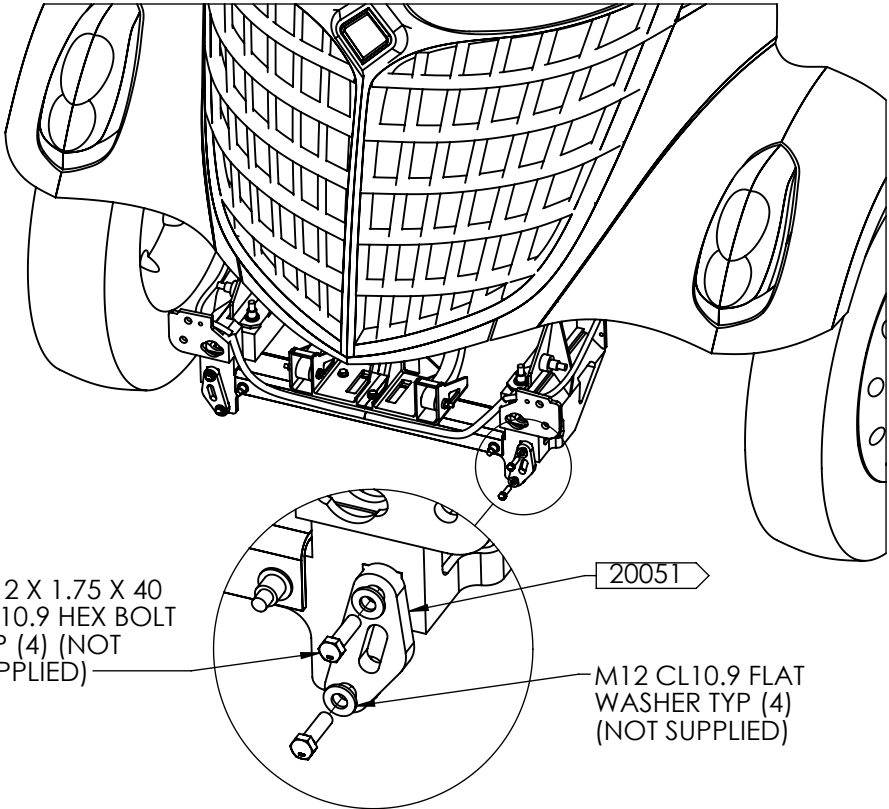

4. INSERT THE TWO TOW MOUNT INSERTS **20056** INTO BOTH TOW SOCKETS AND TURN 90° TO LOCK IN PLACE.

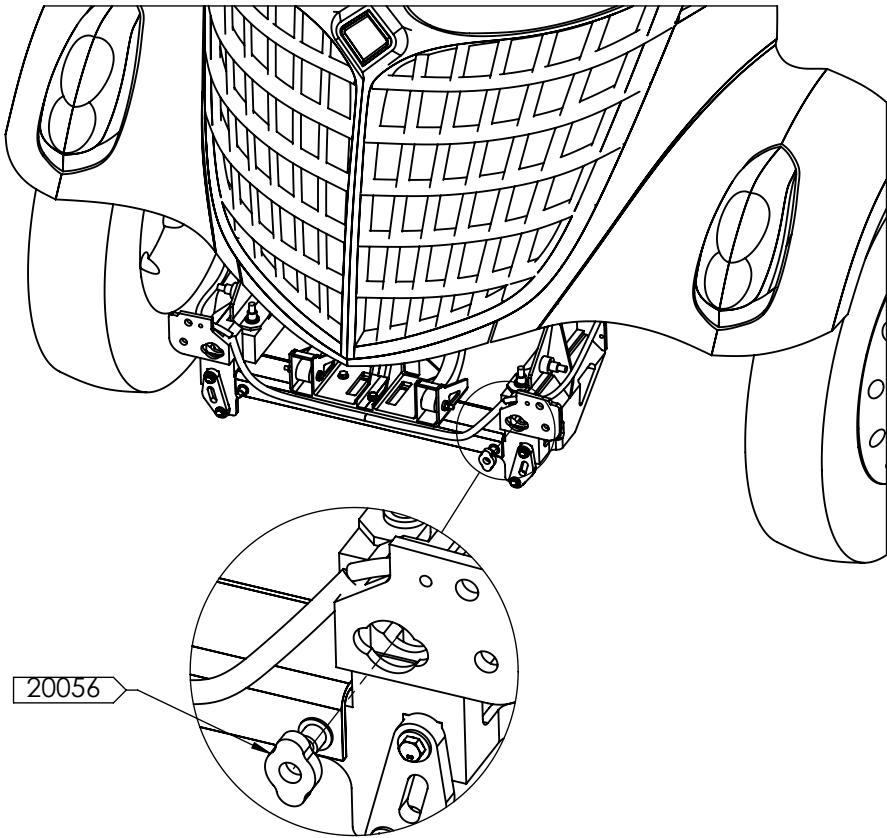

INSTALLATION PROCEDURE

5. INSTALL THE BRACE **20060** AND MOUNT BRACKET **20061** ON THE DRIVER SIDE OF THE TRUCK. REPEAT WITH INSTALLATION WITH **20060M** AND A MOUNT BRACKET **20061** ON THE PASSENGER SIDE OF THE TRUCK. USE THE FOLLOWING HARDWARE TO SECURE THE BRACKETS:

- 4 X **90379** HEX BOLTS
- 2 X **90370** HEX BOLTS
- 12 X **95023** WASHERS
- 6 X **94026** NUTS

TORQUE TO 80 FT-LBS (LUBRICATED) / 110 FT-LBS (DRY).

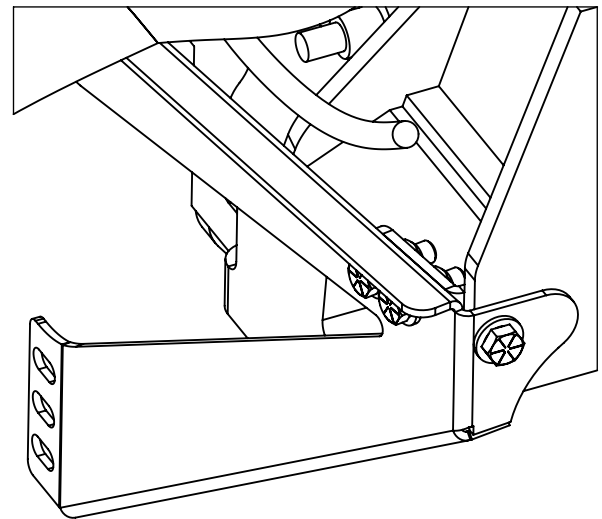
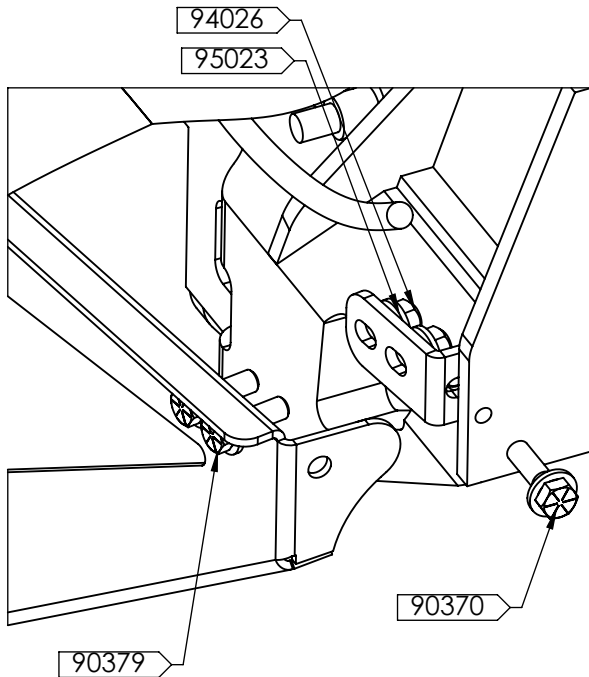
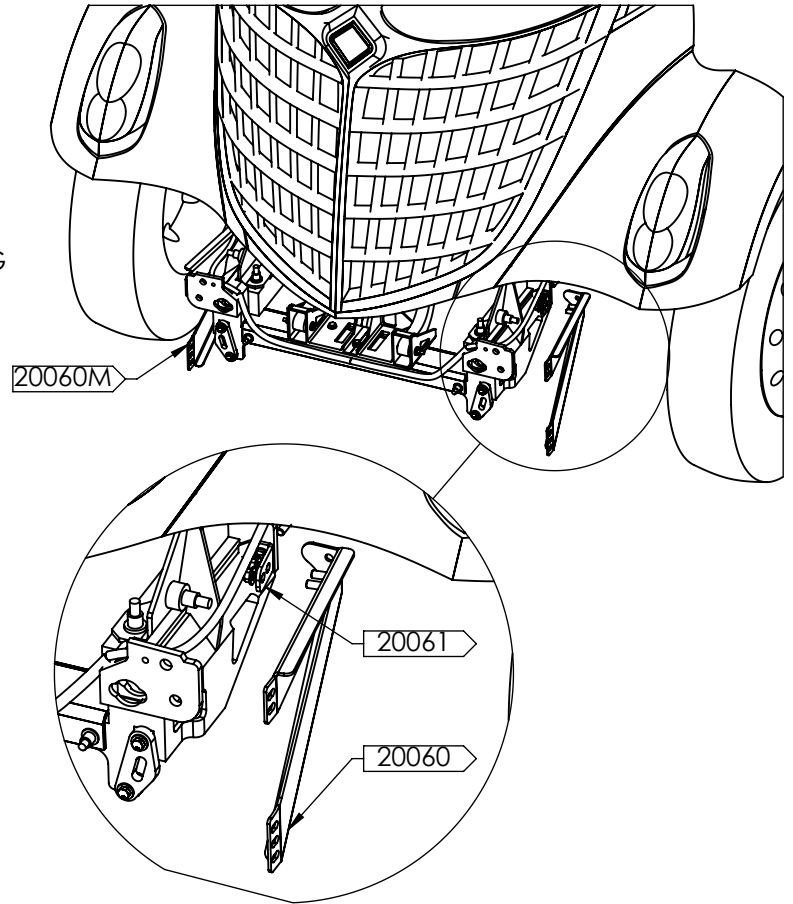



INSTALLATION PROCEDURE

6. POSITION A SPACER **T6530** BETWEEN THE TRUCK FRAME AND STEEL ASSEMBLY OF THE BUMPER. THE **90345** BOLT WILL SLIDE THROUGH THIS SPACER WHEN THE BUMPER IS INSTALLED.

7. ATTACH THE BUMPER TO THE TRUCK USING THE FOLLOWING HARDWARE:

- 4 X (5/8" NC X 2" GR.8 HEX BOLT) (NOT SUPPLIED)
- 8 X (5/8" GR.8 FLAT WASHER) (NOT SUPPLIED)
- 4 X (5/8" NC GR.C STOVER NUT) (NOT SUPPLIED)

TORQUE TO 160 FT-LBS (LUBRICATED) / 210 FT-LBS (DRY).

8. SECURE THE SPACER **T6530** USING THE FOLLOWING HARDWARE:

- 2 X **90345** BOLTS
- 2 X **94013** NUTS
- 4 X **95019** WASHERS

TORQUE TO 160 FT-LBS (LUBRICATED) / 210 FT-LBS (DRY).

9. SECURE THE TOW MOUNT INSERTS **20056** WITH THE FOLLOWING HARDWARE:

- 2 X **90348** BOLTS
- 2 X **95003** WASHERS

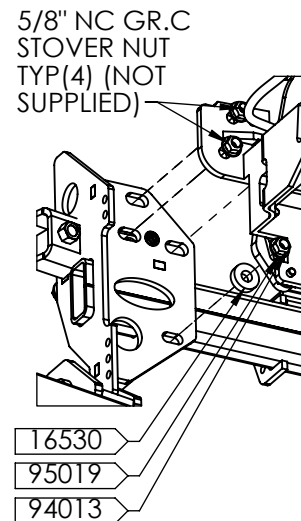
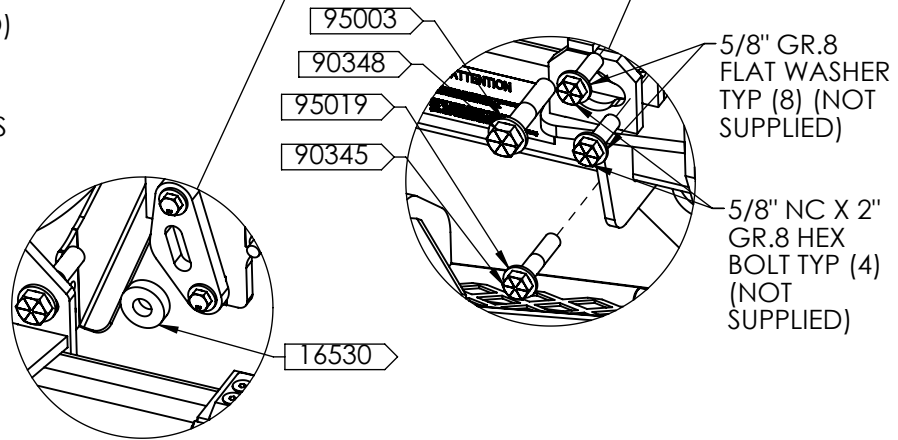
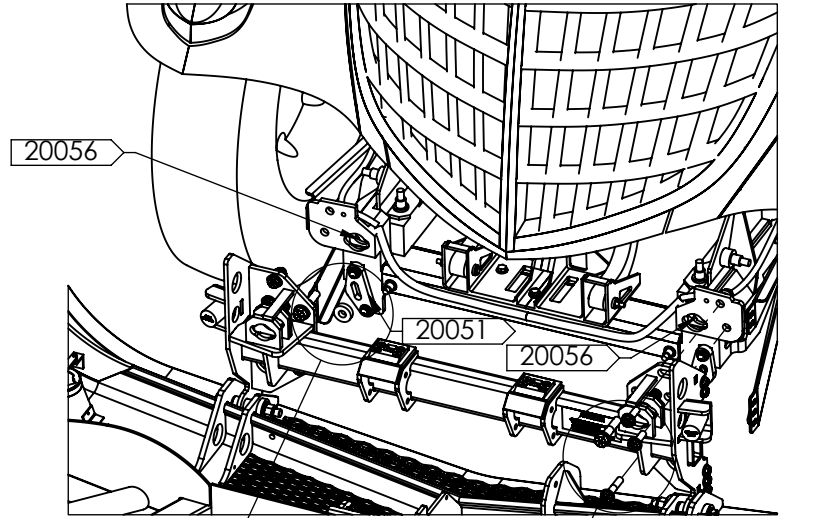

TORQUE TO 160 FT-LBS (LUBRICATED) / 210 FT-LBS (DRY).



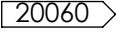
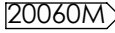

INSTALLATION PROCEDURE

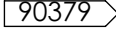
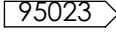
10. ATTACH THE  BRACE TO THE DRIVER SIDE OF THE BUMPER AND  TO THE PASSENGER SIDE OF THE BUMPER. USE THE FOLLOWING HARDWARE:

- 10 X  HEX BOLTS
- 20 X  WASHERS
- 10 X  NUTS

TORQUE TO 80 FT-LBS (LUBRICATED) / 110 FT-LBS (DRY).

IMPORTANT NOTE:

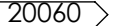
CHECK THE CLEARANCE BETWEEN THE STEERING ARM AND  WHEN IN A LEFT TURN.

11. INSTALL THE LAMPS ON THE PASSENGER AND DRIVER SIDE OF THE BUMPER. SLIDE THEM INTO POSITION FROM THE TOP OF BUMPER AND BOLT THEM TO THE WELDED ON BRACKETS. SILICONE THE TOP OF THE BRACKETS TO THE LAMP AND AROUND THE LAMP IN THE AREAS INDICATED IN THE FIGURE.

CLOSE THE BUMPER WITH CARE AND:

- A. REVIEW FOR ANY INTERFERENCES THAT MIGHT OCCUR.**
- B. CHECK FOR ANY UNWANTED RATTLES OR MOVEMENTS OF THE BUMPER.**

IF YOU HAVE ANY QUESTIONS OR CONCERNS PLEASE REACH OUT TO US.

IF EVERYTHING LOOKS GOOD, THE INSTALL IS COMPLETE, AND PLEASE REMEMBER TO CHECK FOR RATTLES AND UNWANTED MOVEMENTS PERIODICALLY. THANK YOU FOR CHOOSING MAGNUM.

