

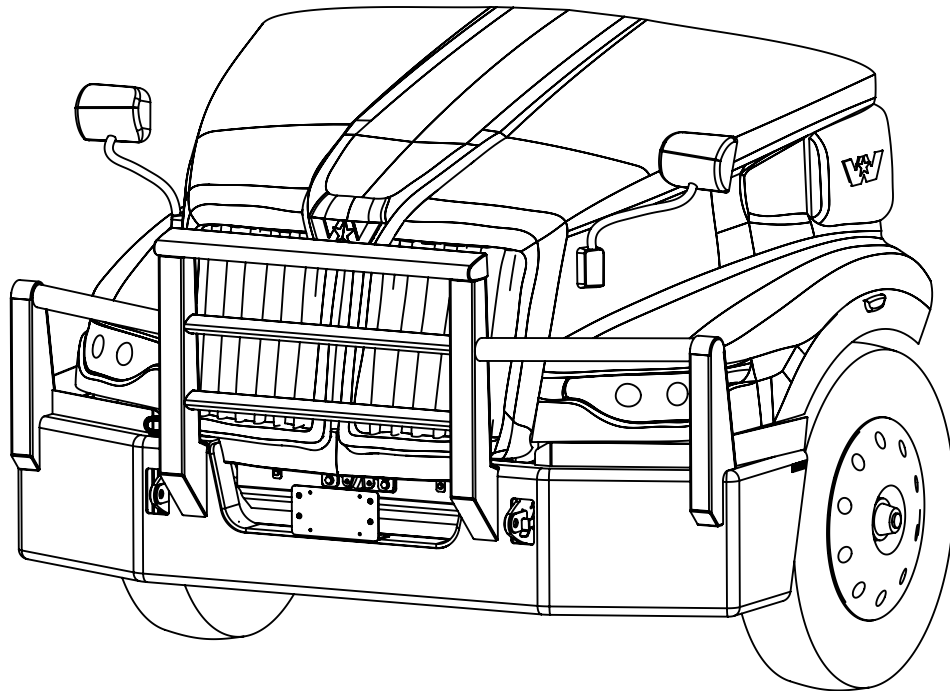

INSTALLATION GUIDE

MODEL NUMBER: 17298

TRUCK MODEL: 2023+ WESTERN STAR 57X SET BACK AXLE



IMPORTANT INFORMATION

- THIS GUIDE IS ONLY APPLICABLE TO PRODUCTS AND TRUCK MODELS SPECIFIED.
- THE CORRECT SIZE AND GRADE OF HARDWARE SPECIFIED IN THIS GUIDE MUST BE USED.
- CHECK ALL MOUNTING POINTS AFTER THE FIRST 5000KM'S IN SERVICE AND PERIODICALLY THERE AFTER. RE-TORQUE IF NECESSARY.
- RECOMMENDED ADDING THREADLOCKER (LOCTITE BLUE 242) TO ALL THREADS BEFORE INSTALLING.
- ALL MAGNUM PRODUCTS MUST BE INSTALLED ACCORDING TO THIS INSTALLATION GUIDE. ANY DEVIATIONS MAY RESULT IN VOID OF WARRANTY.
- ANY ALTERATIONS TO THE PRODUCT MAY RESULT IN VOID OF WARRANTY.

SAFETY INFORMATION

- PROPER PERSONAL PROTECTIVE EQUIPMENT MUST BE WORN WHEN INSTALLING THIS PRODUCT.
- SOME PARTS OF THIS PRODUCT MAY BE HEAVY OR AWKWARD TO HANDLE. USE CAUTION WHEN HANDLING.

17298 MOOSE BUMPER

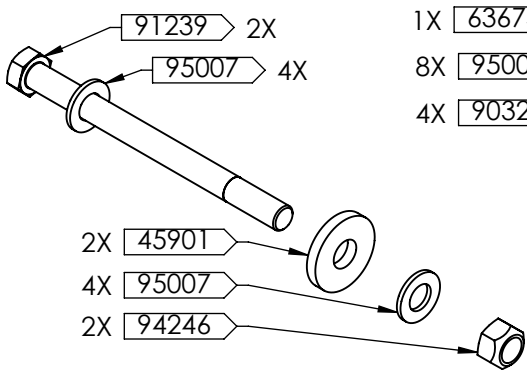
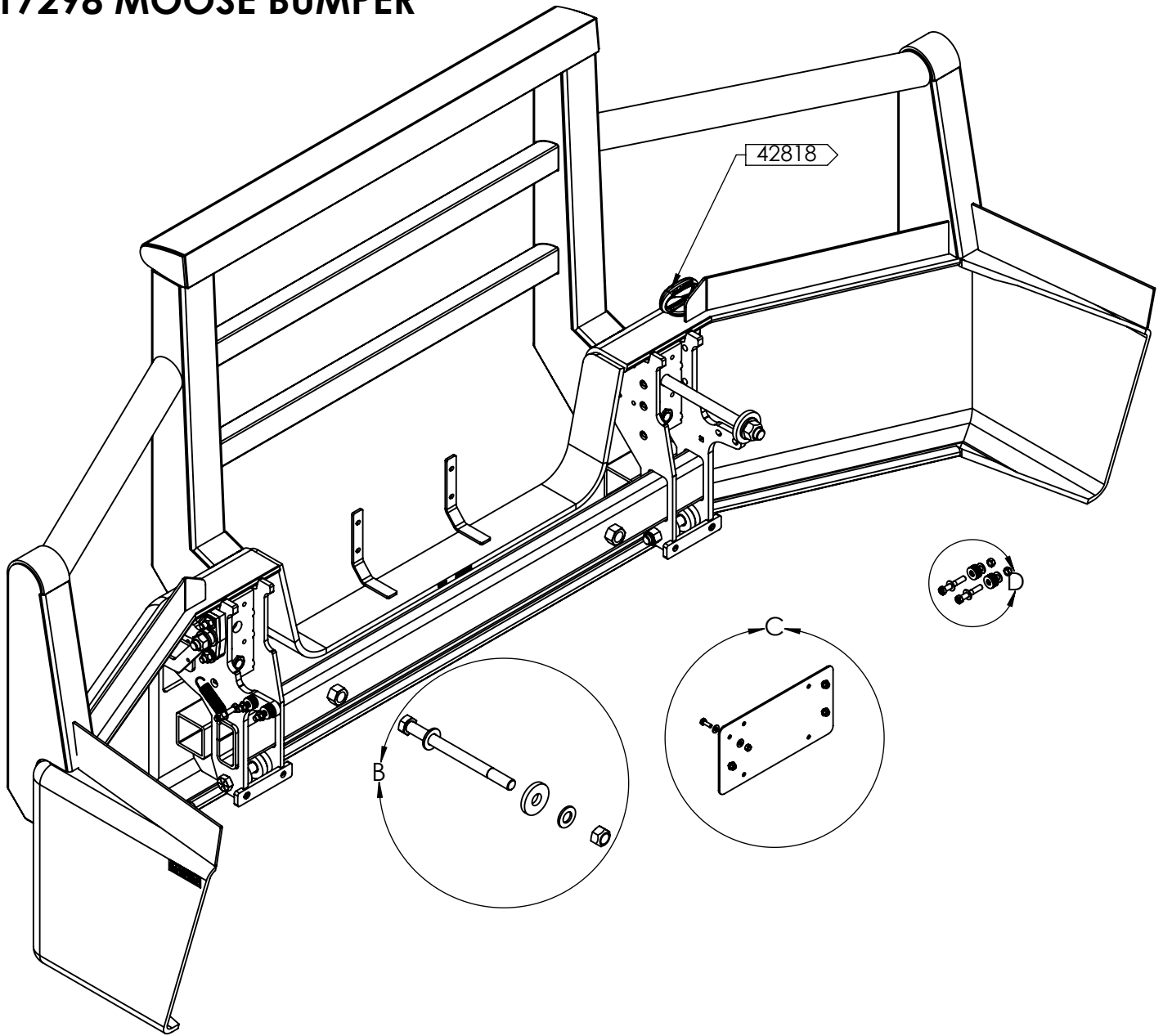

DETAIL B
SCALE 1 : 6

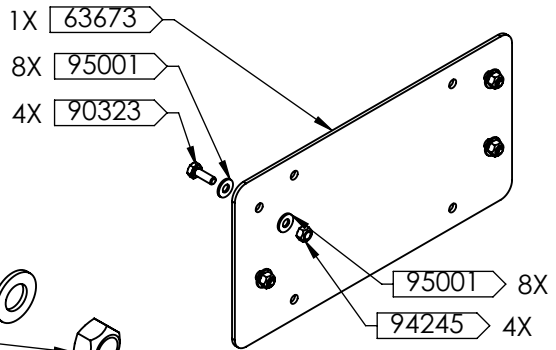

DETAIL C
SCALE 1 : 6

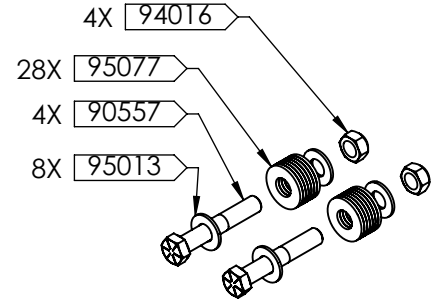

DETAIL D
SCALE 1 : 4

SEE NEXT PAGE FOR LIST OF PARTS INCLUDED



ASSEMBLY KIT PARTS

ITEM#	DESCRIPTION	MAT'L	DIMENSIONS	WT. EA	STOCK #	QTY.
42818	CAST TOWPIN	130-90-09 CAST IRON	Ø1 1/2 X 13 5/8	5.4	125613	1
45901	WASHER PLATE	44W	3/8" PL X 2 5/8" DIA.	.49	126464	2
63673	COVER PLATE	UHMW - BLACK	1/8" PL X 6 1/4" X 12 1/4"	.32	131654	1
90323	HEX HEAD BOLT - PLATED	GR. 5	1/4" NC X 3/4"	.019	101564	4
90557	HEX CAPSCREW - PLATED	GR. 8	3/8" NC X 2 1/4"	.088	126450	4
91239	HEX CAPSCREW - PLATED	GR. 8	7/8" NC X 1 1/2"	2.1	126380	2
94016	STOVER NUT - PLATED	GR. C	3/8" NC	.013	101478	4
94245	STOVER NUT - PLATED	GR. C	1/4 NC	.0082	101476	4
94246	STOVER NUT - PLATED	GR. C	7/8 NC	.19	101480	2
95001	FLAT WASHER - PLATED	GR. 2	1/4" DIA SAE	.0043	102157	8
95007	FLAT WASHER - PLATED	GR. 8	7/8" DIA SAE	.078	102173	4
95013	FLAT WASHER - PLATED	GR. 8	3/8" DIA SAE	.0069	102170	8
95077	FLAT WASHER - PLATED	GR. 2	3/8" DIA USS	.015	105722	28

INSTALLATION PROCEDURE

1. UNINSTALL THE OEM BUMPER FROM THE TRUCK.

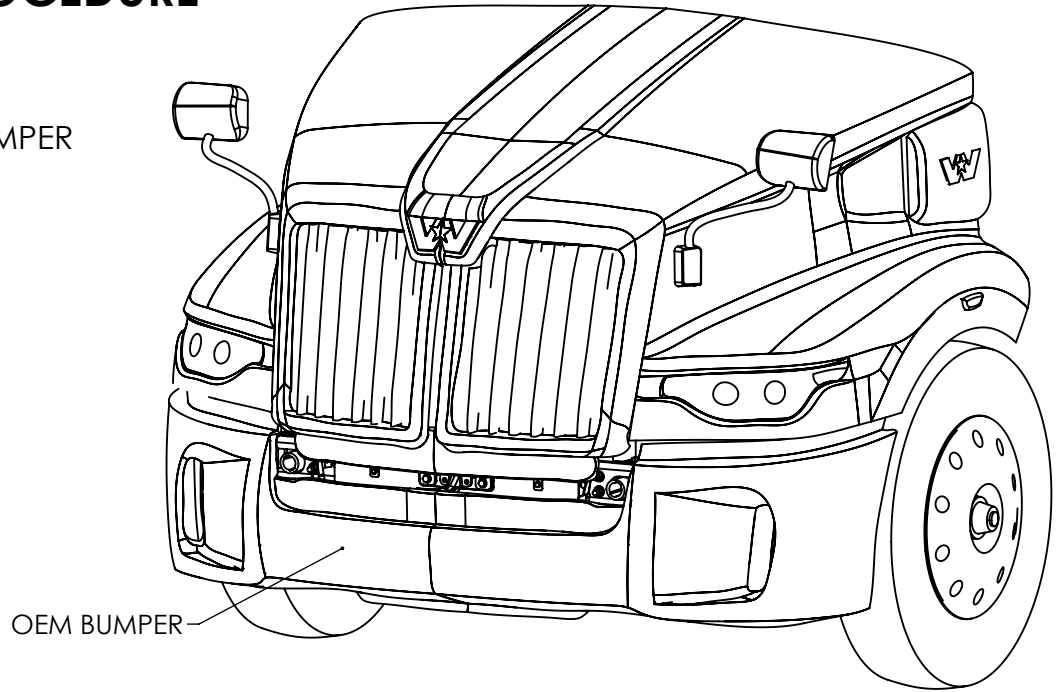

2. UNINSTALL THE PASSENGER SIDE TRUCK BRACKET, DRIVER SIDE TRUCK BRACKET AND THE SPLASH GUARD WITH ITS ASSOCIATED BRACKETS.

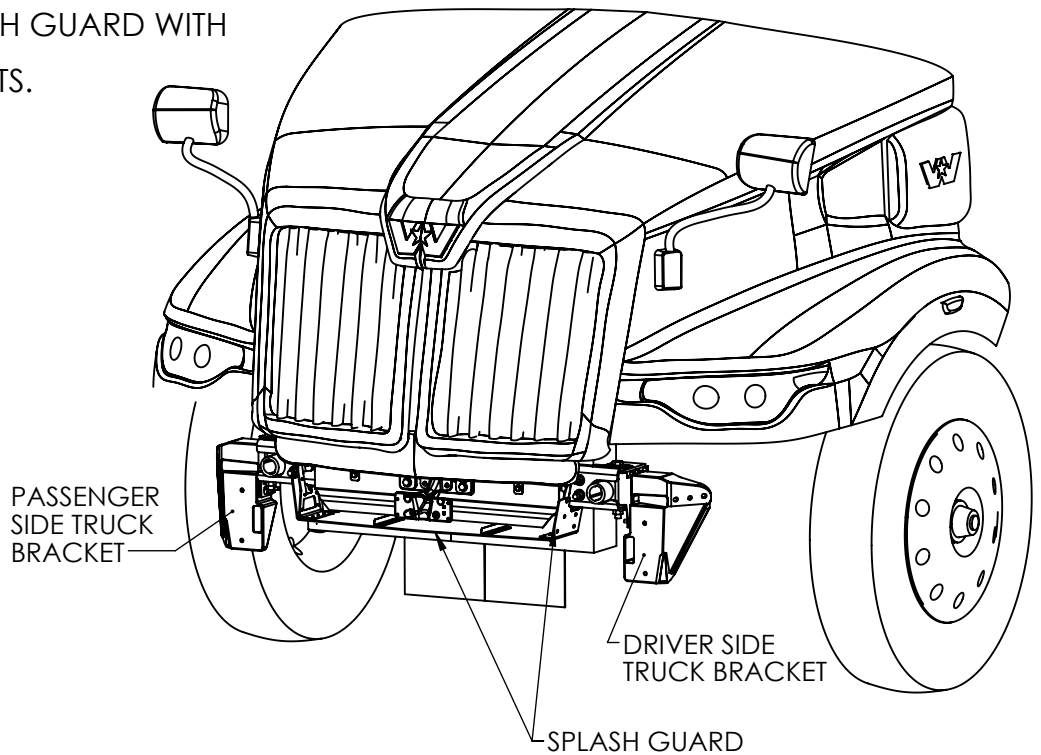

INSTALLATION PROCEDURE

3. THERE ARE TWO OPTIONS FOR THIS STEP, EITHER THE TOP PLASTIC GRILL IS REMOVED COMPLETELY OR IT IS TRIMMED IN ORDER TO FIT THE BUMPER.

IF THE TRIM OPTION IS CHOSEN, WHEN TRIMMING THE GRILL IT IS IMPORTANT TO CLEAR THE AREA SHOWN IN THE FIGURE TO THE RIGHT, SINCE THE GRILL IS A HATCH PATTERN WE RECOMMEND TRIMMING THE PLASTIC TO THE NEAREST INTERSECTING SECTION.

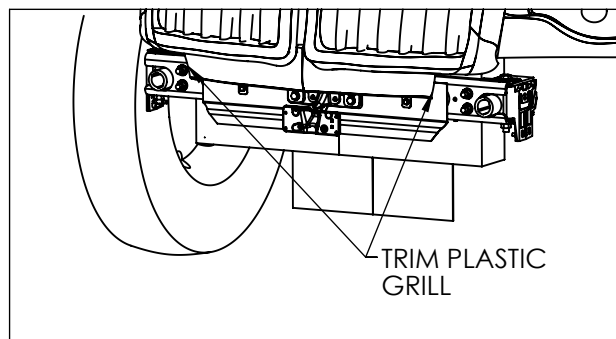
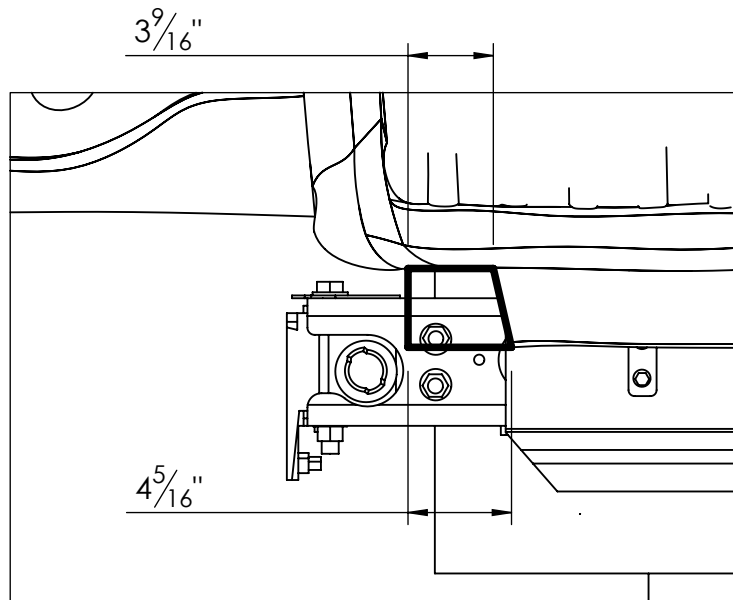
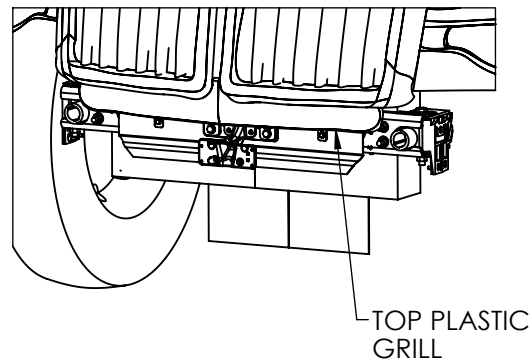



INSTALLATION PROCEDURE

4. SECURE THE BUMPER TO THE TOW RECIEVERS USING THE FOLLOWING HARDWARE:

- 2 X 91239 BOLT
- 4 X 95007 WASHERS
- 2 X 45901 PLATE WASHER
- 2 X 94246 NUTS

TORQUE TO 450 FT-LBS (LUBRICATED) / 600 FT-LBS (DRY).

IF REQUIRED GRIND THE END OF THE BOLT INDICATED IN THE FIGURE. THIS MAY BE NEEDED FOR BUMPER TO SIT SECURELY AGAINST THE FRAME OF THE TRUCK.

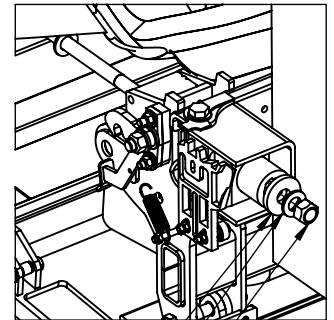
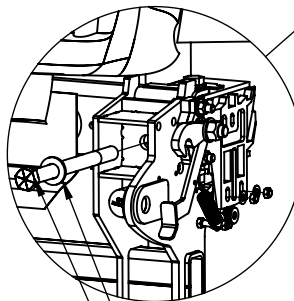
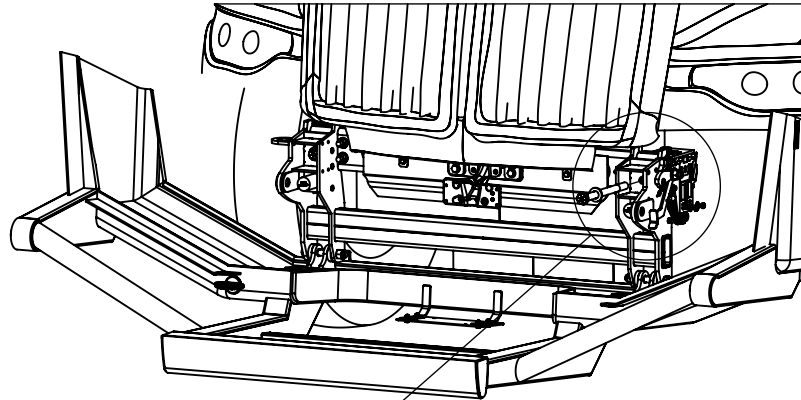

95007
91239

45901
95007
94246

5. ATTACH THE BUMPER TO THE SIDE BRACKETS OF THE TRUCK USING THE FOLLOWING HARDWARE:

- 4 X 90557 BOLTS
- 4 X 94016 NUTS
- 8 X 95013 WASHERS
- 28 X 95077 WASHERS

USE THE 95077 WASHERS AS SPACERS BETWEEN THE BUMPER AND THE TRUCK SIDE BRACKET

TORQUE TO 35 FT-LBS (LUBRICATED) / 45 FT-LBS (DRY).

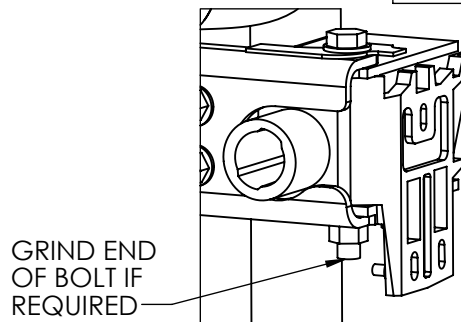

GRIND END OF BOLT IF REQUIRED

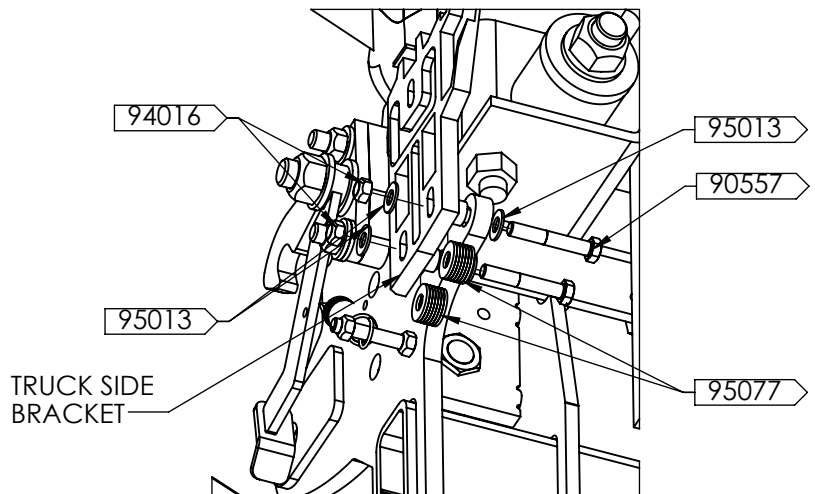

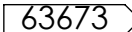

INSTALLATION PROCEDURE

6. MOUNT THE  PLASTIC COVER PLATE ONTO THE TABS ON THE BUMPER. SECURE IT IN PLACE USING THE FOLLOWING HARDWARE:

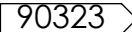
4 X  BOLTS

8 X  WASHERS

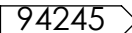
4 X  NUTS

IF THE TRUCK IS NOT EQUIPPED WITH RADAR THIS PLATE CAN BE USED TO MOUNT THE LICENCE PLATE

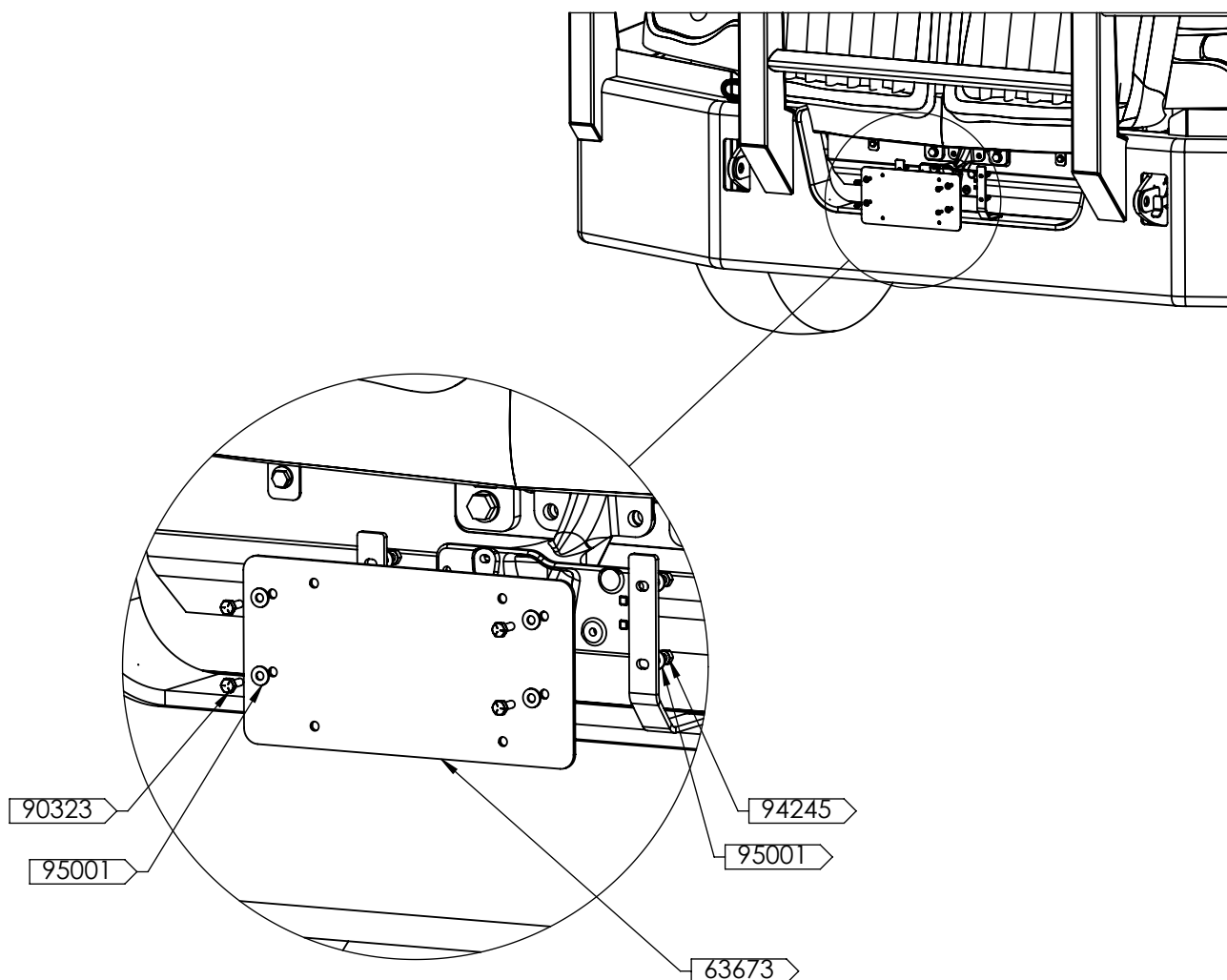



LATCH ADJUSTMENT INSTRUCTIONS

IF NEEDED, HERE ARE THE STEPS ON HOW TO ADJUST THE BUMPER LATCH:

1. SLIGHTLY LOOSEN THE 1/2" LATCH ADJUSTER BOLT.
2. USING A HAMMER, TAP/ PUSH IN THE LATCH ADJUSTER FOR A MORE TIGHTER LATCH CLOSURE, OR TAP/PULL OUT THE LATCH ADJUSTER IF BUMPER NO LONGER FULLY CLOSES.
3. CHECK IF BUMPER CAN FULLY CLOSE.
4. TIGHTEN FIRMLY THE 1/2" LATCH ADJUSTER BOLT.

