

**ATTENTION:**

CHECK THE CROSS MEMBER OF THE TRUCK IN ORDER TO DETERMINE WHETHER THE SPACER PLATE IS REQUIRED. CONTRARY TO THE TWO CONFIGURATIONS OUTLINED IN DETAIL B COULD RESULT IN DAMAGE TO THE BUMPER AND/OR TRUCK.

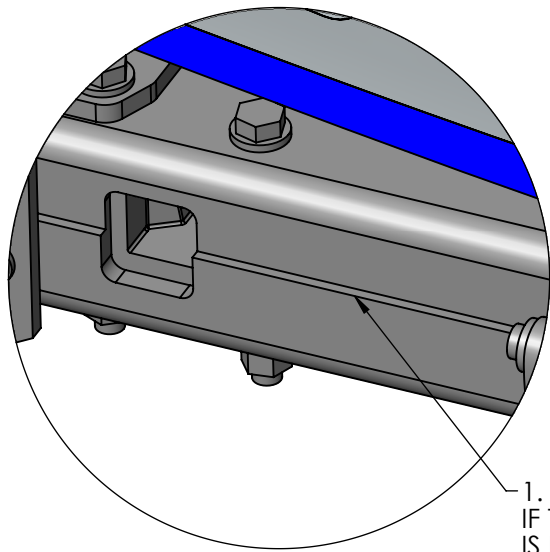
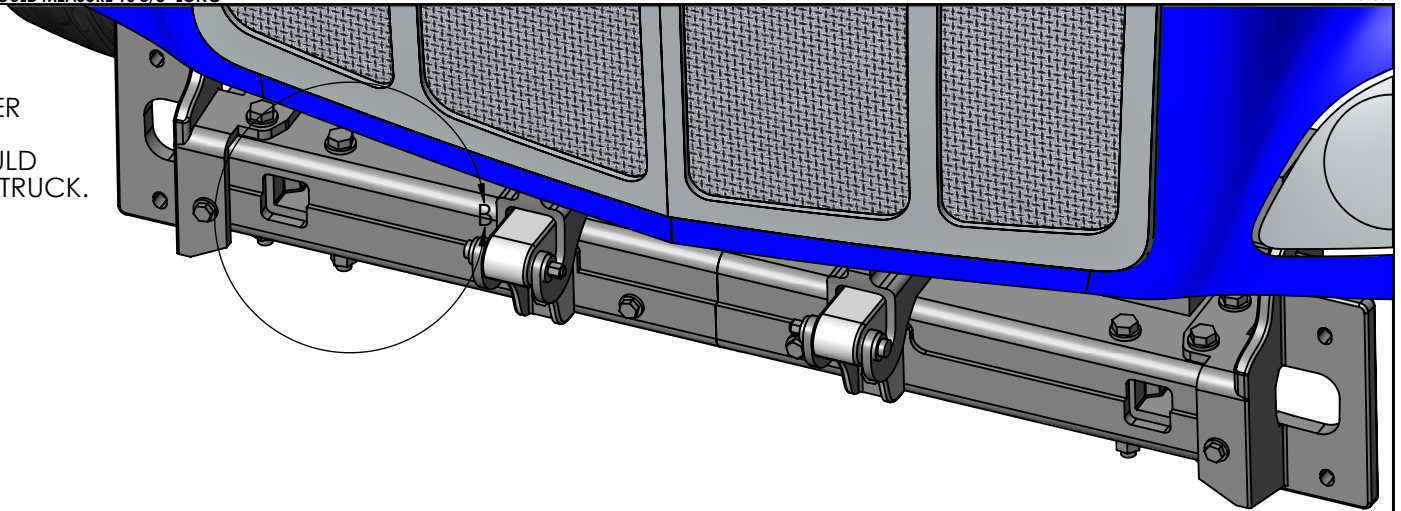

DETAIL B  
SCALE 1 : 4

1. INSPECT CROSS MEMBER FOR RIDGE. IF THERE IS A RIDGE THE SPACER PLATE IS REQUIRED.

2. IF TRUCK CROSS MEMBER IS FLAT, SPACER IS NOT REQUIRED.

IF SPACER PLATE IS NOT REQUIRED:  
GRIND OFF TAC WELDS AND REMOVE SPACER. PAINT BARE METAL TO PREVENT CORROSION. REPEAT FOR OTHER MOUNTING BRACKET.

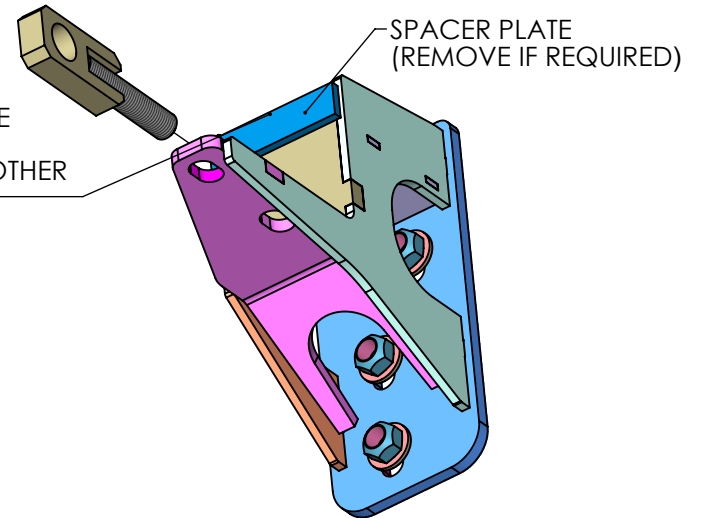

MOUNTING BRACKET ASSEMBLY

**MAGNUM TRAILER & EQUIPMENT INC.**



**FRACTIONS CHART**

1/32	.03125	9/32	.28125	17/32	.53125	25/32	.78125
1/16	.0625	5/16	.3125	9/16	.5625	13/16	.8125
3/32	.09375	11/32	.34375	19/32	.59375	27/32	.84375
1/8	.125	3/8	.375	5/8	.625	7/8	.875
5/32	.15625	13/32	.40625	21/32	.65625	29/32	.90625
3/16	.1875	7/16	.4375	11/16	.6875	15/16	.9375
7/32	.21875	15/32	.46875	23/32	.71875	31/32	.96875
1/4	.25	1/2	.5	3/4	.75		

UNLESS OTHERWISE SPECIFIED DIMENSIONS ARE IN INCHES TOLERANCES ARE:

FRACTIONS	ANGLES
+/- 1/16"	+/- 1°
.XX"	.XXX"
+/- 0.03"	+/- 0.005"

DIMENSIONS TO SHARP POINTS

SHEET NAME <b>SPACER PLATE</b>		TITLE <b>17257 BUMPER ON 2013 PETERBILT 579</b>		
CURRENT CUSTOMER	STOCK NUMBER	VENDOR NUMBER	WEIGHT - LB.	
<b>WO#</b>	DRAWN BY GW	DRAWN DATE 2018-12-18	REV. <b>B</b>	
SCALE 1:8	MODELLER GW	DRAWING NUMBER <b>AA-51060</b>	NUMBER OF SHEETS 2	

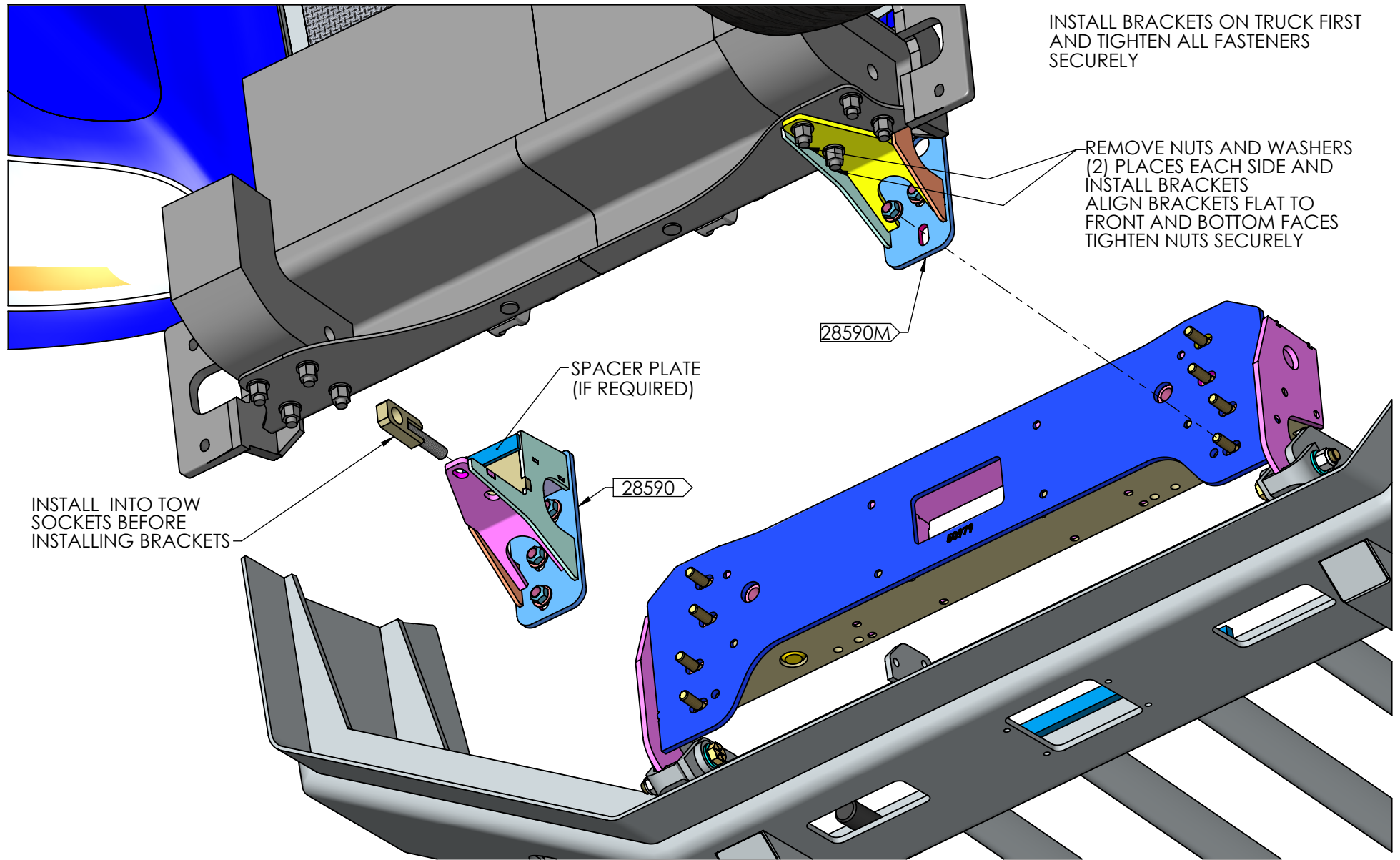

**MAGNUM TRAILER & EQUIPMENT INC.**



**FRACTIONS CHART**

1/32	.03125	9/32	.28125	17/32	.53125	25/32	.78125
1/16	.0625	5/16	.3125	9/16	.5625	13/16	.8125
3/32	.09375	11/32	.34375	19/32	.59375	27/32	.84375
1/8	.125	3/8	.375	5/8	.625	7/8	.875
5/32	.15625	13/32	.40625	21/32	.65625	29/32	.90625
3/16	.1875	7/16	.4375	11/16	.6875	15/16	.9375
7/32	.21875	15/32	.46875	23/32	.71875	31/32	.96875
1/4	.25	1/2	.5	3/4	.75		

UNLESS OTHERWISE SPECIFIED DIMENSIONS ARE IN INCHES TOLERANCES ARE:

FRACTIONS	ANGLES
+/- 1/16"	+/- 1°
.XX"	.XXX"
+/- 0.03"	+/- 0.005"

DIMENSIONS TO SHARP POINTS

SHEET NAME		TITLE	
BRACKET INSTALL		17257 BUMPER ON 2013 PETERBILT 579	
CURRENT CUSTOMER	STOCK NUMBER	VENDOR NUMBER	WEIGHT - LB.
WO#	DRAWN BY	DRAWN DATE	REV.
	GW	2018-12-18	B
SCALE	MODELLER	DRAWING NUMBER	NUMBER OF SHEETS
1:8	GW	AA-51060	2

**ONLY USE FASTENERS AND GRADES SPECIFIED**

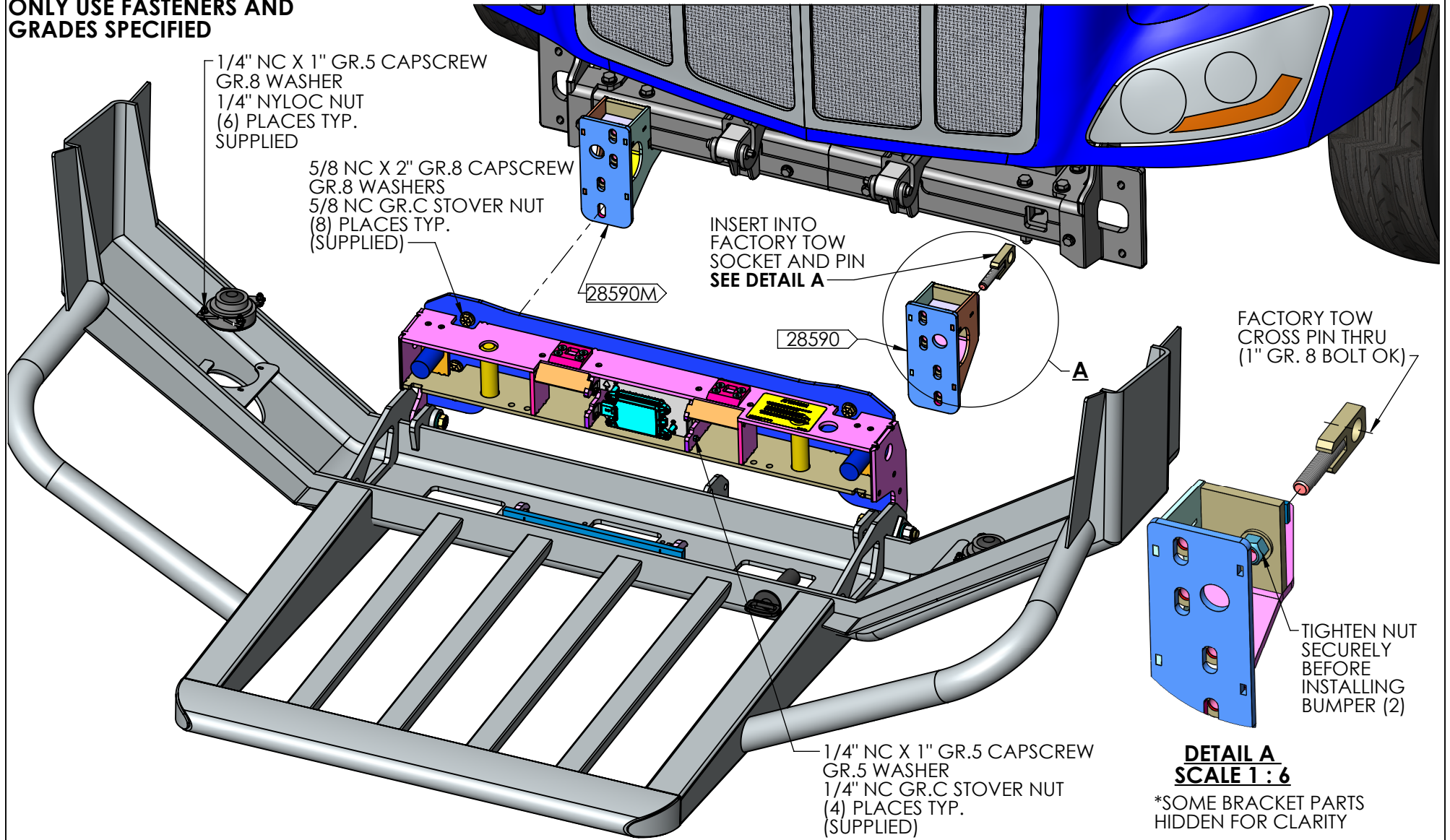

1/4" NC X 1" GR.5 CAPSCREW  
GR.8 WASHER  
1/4" NYLOC NUT  
(6) PLACES TYP.  
SUPPLIED

5/8 NC X 2" GR.8 CAPSCREW  
GR.8 WASHERS  
5/8 NC GR.C STOVER NUT  
(8) PLACES TYP.  
(SUPPLIED)

INSERT INTO  
FACTORY TOW  
SOCKET AND PIN  
SEE DETAIL A

FACTORY TOW  
CROSS PIN THRU  
(1" GR. 8 BOLT OK)

TIGHTEN NUT  
SECURELY  
BEFORE  
INSTALLING  
BUMPER (2)

1/4" NC X 1" GR.5 CAPSCREW  
GR.5 WASHER  
1/4" NC GR.C STOVER NUT  
(4) PLACES TYP.  
(SUPPLIED)

**DETAIL A  
SCALE 1 : 6**

\*SOME BRACKET PARTS  
HIDDEN FOR CLARITY

**MAGNUM TRAILER & EQUIPMENT INC.**

FRACTIONS CHART					
1/32	.03125	9/32	.28125	17/32	.53125
1/16	.0625	5/16	.3125	9/16	.5625
3/32	.09375	11/32	.34375	13/16	.8125
1/8	.125	3/8	.375	19/32	.59375
5/32	.15625	13/32	.40625	5/8	.625
3/16	.1875	7/16	.4375	21/32	.65625
7/32	.21875	15/32	.46875	29/32	.90625
1/4	.25	1/2	.5	11/16	.6875
				15/16	.9375
				23/32	.71875
				31/32	.96875
				3/4	.75

UNLESS OTHERWISE SPECIFIED  
DIMENSIONS ARE IN INCHES  
TOLERANCES ARE:

FRACTIONS	ANGLES
+/- 1/16"	+/- 1°
.XX"	.XXX"
+/- 0.03"	+/- 0.005"

DIMENSIONS TO SHARP POINTS

SHEET NAME		TITLE	
BUMPER INSTALL		17257 BUMPER ON 2013 PETERBILT 579	
CURRENT CUSTOMER	STOCK NUMBER	VENDOR NUMBER	WEIGHT - LB.
WO#	DRAWN BY	DRAWN DATE	REV.
	GW	2018-12-18	B
SCALE	MODELLER	DRAWING NUMBER	NUMBER OF SHEETS
1:12	GW	AA-51060	2

**USE ONLY FASTENERS AND GRADES SPECIFIED**

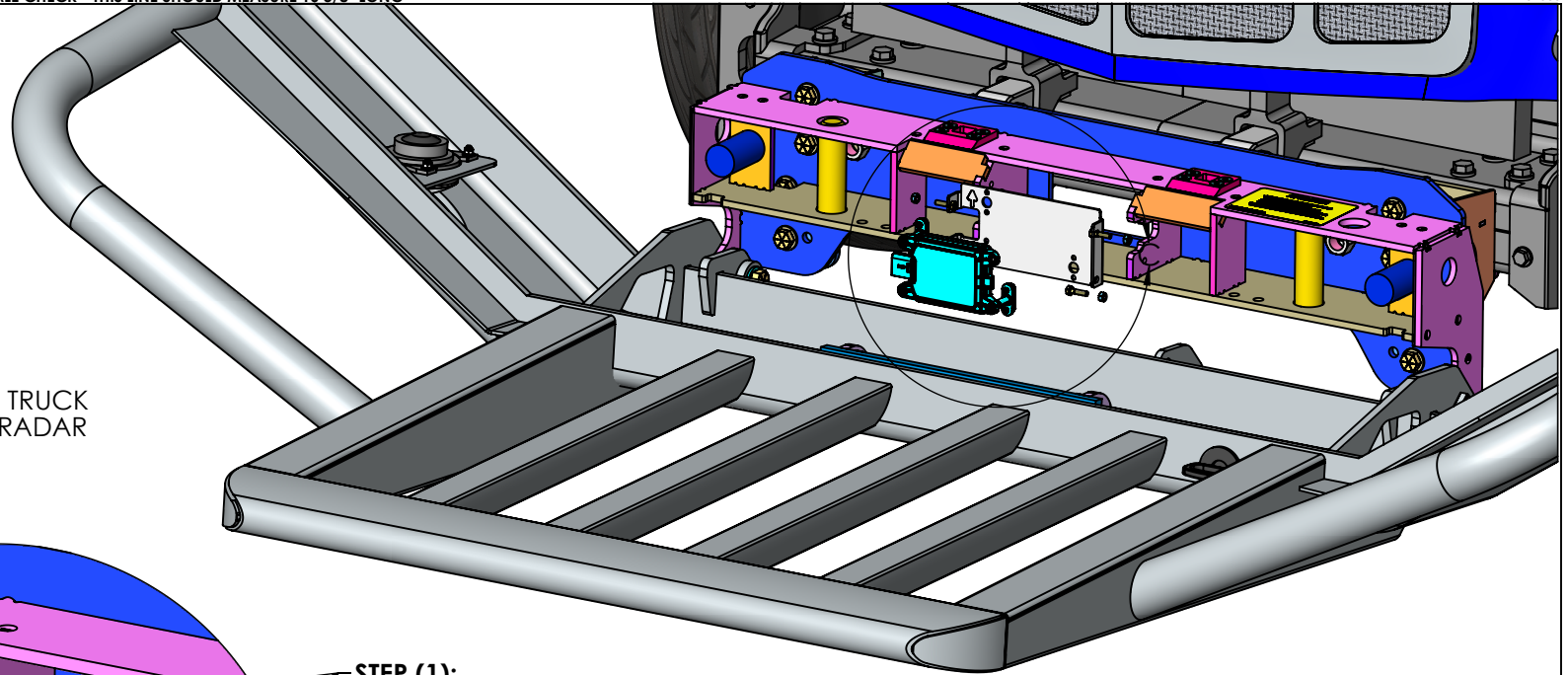

**STEP (2):**  
RECONNECT RADAR TO THE TRUCK  
(USE BRACKET SLOT TO FISH RADAR  
CABLE)

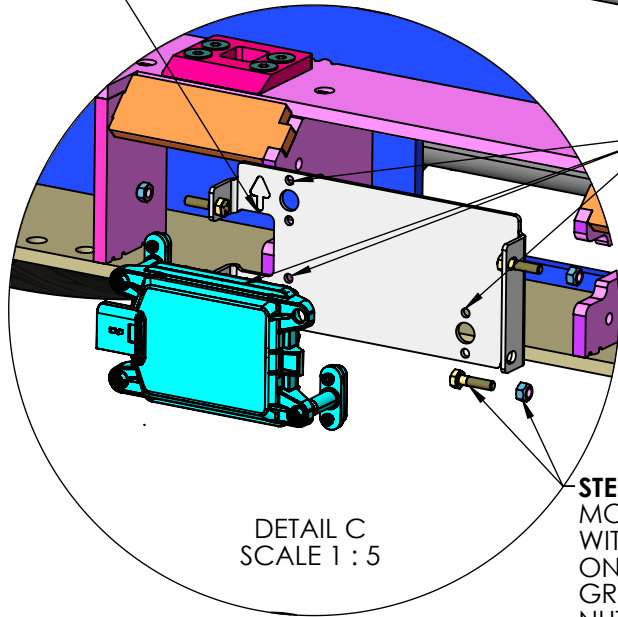

DETAIL C  
SCALE 1 : 5

**STEP (1):**  
INSTALL RADAR INTO RADAR  
BRACKET SUPPLIED REUSING  
ORIGINAL ADJUSTABLE STAND-OFF  
AND FASTENERS

**STEP (3):**  
MOUNT RADAR BRACKET  
WITH RADAR INSTALLED  
ON IT USING 1/4" NC X 1"  
GR. 5 AND GR. C STOVER  
NUTS (SUPPLIED)(4) PLACES

**NOTE:**  
IF EQUIPED, RADAR MUST BE REMOVED BEFORE BUMPER INSTALLATION.

**RADAR MUST BE RE-CALIBRATED AFTER BUMPER INSTALLATION.  
CALIBRATION CAN ONLY BE DONE BY AUTHORIZED PERSONNEL**

**MAGNUM TRAILER  
&  
EQUIPMENT INC.**



**FRACTIONS CHART**

1/32	.03125	9/32	.28125	17/32	.53125	25/32	.78125
1/16	.0625	5/16	.3125	9/16	.5625	13/16	.8125
3/32	.09375	11/32	.34375	19/32	.59375	27/32	.84375
1/8	.125	3/8	.375	5/8	.625	7/8	.875
5/32	.15625	13/32	.40625	21/32	.65625	29/32	.90625
3/16	.1875	7/16	.4375	11/16	.6875	15/16	.9375
7/32	.21875	15/32	.46875	23/32	.71875	31/32	.96875
1/4	.25	1/2	.5	3/4	.75		

UNLESS OTHERWISE SPECIFIED  
DIMENSIONS ARE IN INCHES  
TOLERANCES ARE:

FRACTIONS	ANGLES
+/- 1/16"	+/- 1°
.XX"	.XXX"
+/- 0.03"	+/- 0.005"

**DIMENSIONS TO SHARP POINTS**

SHEET NAME	TITLE		
RADAR INSTALL	17257 BUMPER ON 2013 PETERBILT 579		
CURRENT CUSTOMER	STOCK NUMBER	VENDOR NUMBER	WEIGHT - LB.
<b>WO#</b>	DRAWN BY	DRAWN DATE	REV.
	GW	2018-12-18	<b>B</b>
SCALE	MODELLER	DRAWING NUMBER	NUMBER OF SHEETS
1:12	GW	<b>AA-51060</b>	2

**ATTENTION:**  
INSTALLING THE LICENSE PLATE ON  
THE RADAR COVER PLATE MAY INTERFERE  
WITH THE RADAR.

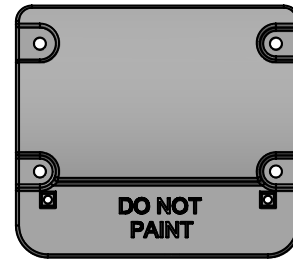
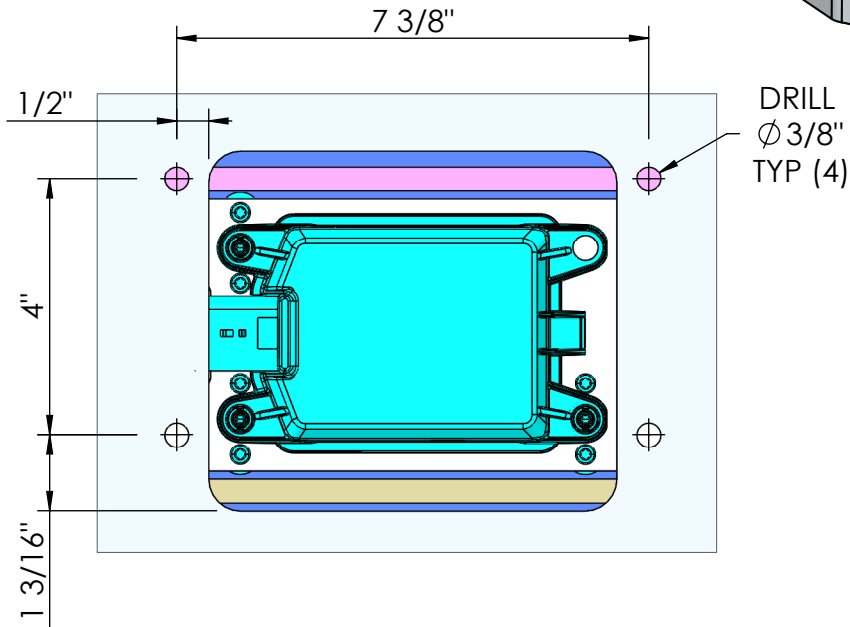
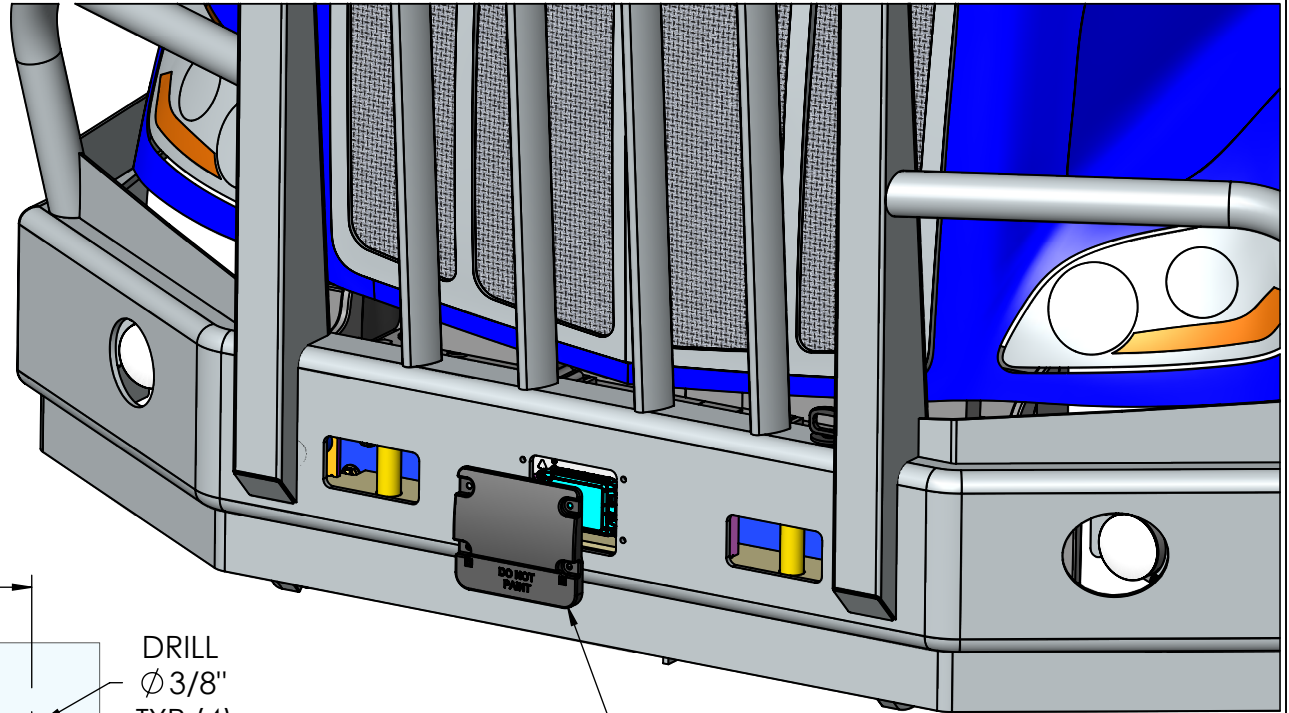

RADAR COVER PLATE

REMOVE COVER PLATE FROM THE  
ORIGINAL BUMPER AND INSTALL USING  
3/8" HARDWARE (NOT SUPPLIED).

**MAGNUM TRAILER  
&  
EQUIPMENT INC.**



**FRACTIONS CHART**

1/32	.03125	9/32	.28125	17/32	.53125	25/32	.78125
1/16	.0625	5/16	.3125	9/16	.5625	13/16	.8125
3/32	.09375	11/32	.34375	19/32	.59375	27/32	.84375
1/8	.125	3/8	.375	5/8	.625	7/8	.875
5/32	.15625	13/32	.40625	21/32	.65625	29/32	.90625
3/16	.1875	7/16	.4375	11/16	.6875	15/16	.9375
7/32	.21875	15/32	.46875	23/32	.71875	31/32	.96875
1/4	.25	1/2	.5	3/4	.75		

UNLESS OTHERWISE SPECIFIED  
DIMENSIONS ARE IN INCHES  
TOLERANCES ARE:

FRACTIONS	ANGLES
+/- 1/16"	+/- 1°
.XX"	.XXX"
+/- 0.03"	+/- 0.005"

DIMENSIONS TO SHARP POINTS

SHEET NAME  
**RADAR COVER**

CURRENT CUSTOMER

**WO#**

SCALE  
1:12

TITLE  
**17257 BUMPER ON 2013 PETERBILT 579**

STOCK NUMBER

DRAWN BY  
GW

MODELLER  
GW

VENDOR NUMBER

DRAWN DATE  
2018-12-18

DRAWING NUMBER  
**AA-51060**

WEIGHT - LB.

REV.  
**B**

NUMBER OF SHEETS  
2